



OnCollab A10

Wireless Conference Collaboration System

User Manual v2



OnCollab A10 Introduction	1
01 Product Features	1
Interface Overview	2
Starting OnCollab A10	3
OnCollab A10 Casting Screen	4
01 Wireless Screen Projection	6
02 Projection Screen	9
03 Screen Projection Settings	10
04 Touchback Control	12
05 OnCollab A10 Settings	13
06 Moderator Mode	14
07 OnCollab MultiCast	16
AVACAST App	18
01 AVACAST Windows App (AVACAST Win TX)	18
Install AVACAST App on Windows	19
Opening AVACAST Windows	19
AVACAST Windows App User Interface	21
Screen Projection	22
Dual Direction Control	23
BYOM	25
Settings	26
02 AVACAST Mac App (AVACAST Mac TX)	27
Install AVACAST App on Mac	28
Opening AVACAST Mac	28
AVACAST Mac App User Interface	30
Screen Projection	31
Dual Direction Control	32
BYOM	34
Settings	35
03 AVACAST Android App (AVACAST Android TX)	36
Install AVACAST App on Android	37
Opening AVACAST Android	37
Notification Bar Control Panel Guide	39
Dual Direction Control	39
Settings	40
04 AVACAST iOS/iPadOS App (AVACAST iOS/iPadOS TX)	41
Install AVACAST App on iOS/iPadOS	42
Opening AVACAST iOS/iPadOS	42
Dual Direction Control	44
Settings	45

01

Product Features



OmniCast

A10 supports casting via Airplay, Google Cast, Miracast, Windows, MacOS, iOS, ChromeOS, and Android.



Automatic Split Screen

Supports simultaneous casting from 2 different devices.



BYOM

Supports USB cameras & speakerphones.

*Requires MJPEG format support.

*Only the full version has this feature.



Dual Direction Control

Mirror and control your participant's device from your screen.



CollabSpot

Draw, annotate & interact; collab together on a central screen.



AVANote

Easily take notes while casting your screen or mirroring the main display to your device.



Multicast

A10 supports both one-to-many group broadcast screen or many-to-one screen casting.



Plug & Cast

No installation required.

Connect and project immediately.



OCC

Experience true One Click Casting when combining OnCollab A10 and AT-C/H.



MTR

A10 is fully compatible with Microsoft Teams Rooms (MTR), one of the leading standards for collaboration spaces.



MIT

AVA products are developed and made in Taiwan.



Other Features

WiFi 6 | AMS | 4K Casting | 4K Video Output | Customizable Standby Screen



- 1
- 2
- 3
- 4
- 5



- 6
- 7
- 8
- 9
- 10

Front Side

Feature Items	Description
1 Power Button	Power on/off
2 Network Status Indicator	Display network status
3 Power Status Indicator	Display power status
4 USB 2.0	USB Type A port for mouse / keyboard / touch screen / USB camera / USB speakerphone
5 USB 3.0	USB Type A port for mouse / keyboard / touch screen / USB camera / USB speakerphone / AT Pairing

Back Side

Feature Items	Description
6 HDMI 2.0 Input Port	Supports up to 4K 60Hz
7 LAN	Ethernet cable can be connected here
8 HDMI 2.0 Output Port	Supports up to 4k 60Hz
9 RS232 Interface	*Not in use
10 Power Input	DC 12V/2A

Setup OnCollab A10

1 Power

Connect the supplied AC adapter.



2 Display

Connect the HDMI Out port to a monitor display.

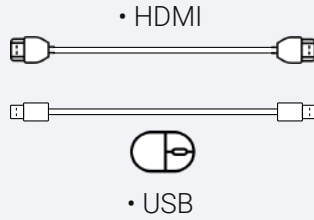

3 Touchscreen and Mouse

Connect using USB to enable touchscreen and/or mouse.

4 Network

Your OnCollab Unit has to be connected to the same network as your personal device.

LAN Cable



Simply connect a suitable ethernet cable from your network to the OnCollab Unit.

Wi-Fi



Open the “System Settings” and you can choose which Wi-Fi to connect to.

Hotspot



Open the “System Settings” and then enable hotspot. The default password is 12345678.

5 Startup

The OnCollab Unit starts automatically when power is connected.



6 Standby Screen

A normal default display screen is featured below for your reference.



Standby Screen Functions



Feature Item	Description
1 Screen Toolbar	OnCollab A10 Screen Toolbar
2 Settings	Open Settings Tab
3 Moderator Mode	Control and manage devices linked to the OnCollab device
4 OnCollab MultiCast	Screens from an A10 can be shared with other OnCollab devices
Display Information	Description
1 Status Bar	OnCollab A10 Status Bar
2 Date & Time	Shows the current date and time
3 AVACAST App Installation	Enter the URL or scan the QR Code to download
3 Network Status	Displays the name of the currently connected Wi-Fi or hotspot ; LAN when connected via Ethernet
4 OnCollab Unit	Displays the OnCollab device name for this device
5 Login Code	4-digit number to ensure that the transmitter is connected to the correct receiver

Status Bar

Click the logo to return to the standby screen

OnCollab Device Name

Login Code

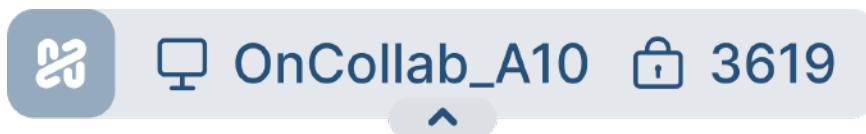

Hide Status Bar



Show Status Bar

Screen Toolbar



Show Screen Toolbar

1

2

3

4

5

Hide Screen Toolbar



CollabSpot Mode

When any personal device enables the CollabSpot's dual direction control and starts annotating, the toolbar icon will turn orange and automatically switch into pen mode

Description

- 1 Turn annotation mode on. The pen icon will turn orange when in use
- 2 Undo the last action
- 3 Turn erasing mode on. The eraser icon will turn orange when in use
- 4 Deletes all annotation from the screen
- 5 Screenshot and share current screen

01

Wireless Screen Projection

The wireless screen projection feature allows personal devices to cast their screens to the OnCollab A10 via WiFi or a wired network. The OnCollab A10 must be on the same network as the personal device (except when using AT-C/AT-H).



OnCollab A10 supports screen sharing through AT-C/AT-H, AVACAST software, AirPlay, Google Cast, and Miracast.

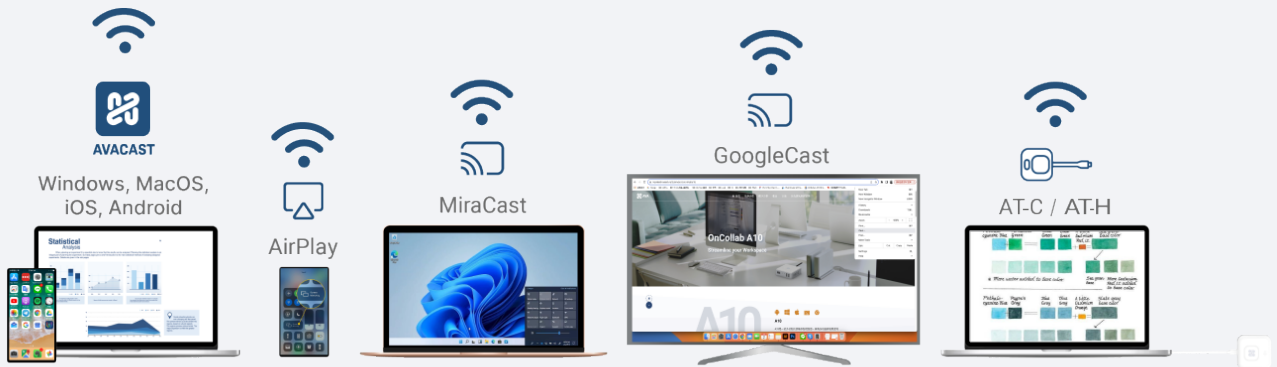

AT-C/AT-H

AT-C/AT-H allows devices to cast their screens directly to OnCollab A10 without installing additional software or connecting to a network. This plug-and-play solution eliminates security concerns, making it ideal for external guests.

1
Insert a paired AT-C or AT-H into the device's USB Type-C or HDMI port.

2
When the large LED indicator turns solid blue, press the button to start casting.





AVACAST Tx App

AVACAST Tx can be installed on Windows, Mac, Android, and iOS devices to cast screens to OnCollab A10.

1

Download and Install AVACAST Tx App



2

After opening the app, select the OnCollab A10 you want to cast to and enter the verification code displayed on the standby screen.



3

After connecting, press the projection button on the left to start projection.



Google Cast

Google Cast is available on the Chrome and Chromium-based Edge browsers for PC.

1

Open options menu on the upper right

2

Chrome – Select Cast, Save and Share → Cast
Edge – Select More Tools → Cast Media to Device

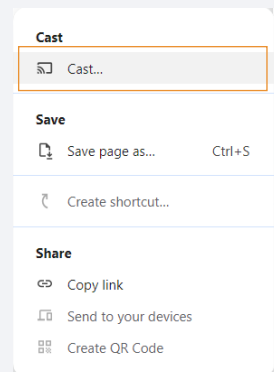
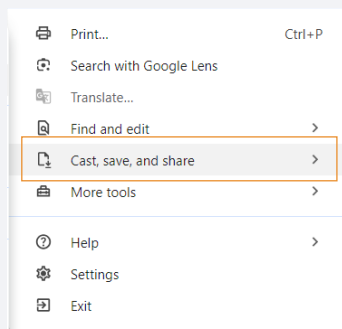

3

Select the OnCollab A10 you want to project to. You can choose to project to a browser tab or your screen in the source.

*OnCollab A10 only supports casting the YouTube tab via screen casting.

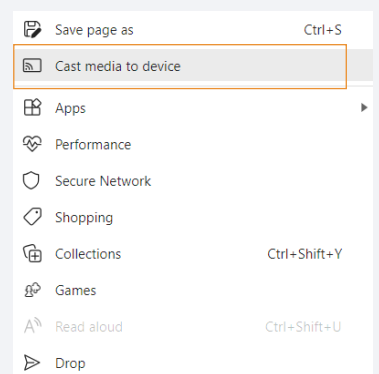
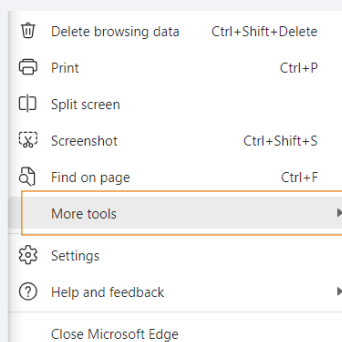



Airplay

iPad, Macbook, iPhone can use Airplay to project images to OnCollab A10.

1

Select Screen Mirroring in the upper right corner of your iPad, Macbook or iPhone.

2

After turning it on, select the OnCollab A10 you want to project and enter the login code on the standby screen.

3

Projection will begin after entering the correct login code.

*OnCollab A10 only supports Airplay screen mirroring output projection.

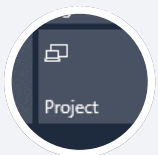

Miracast

Windows devices can project images to the OnCollab A10 using Miracast. Your A10 must be connected to the network via WiFi (Hotspot and LAN connections are not supported).

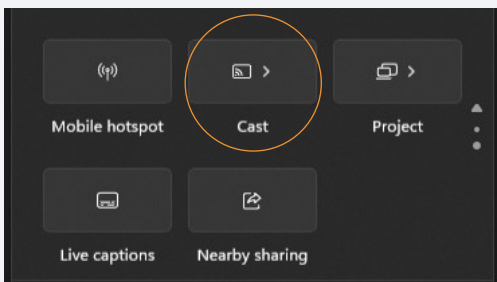

1

Click the notification center in the bottom right corner and select Cast

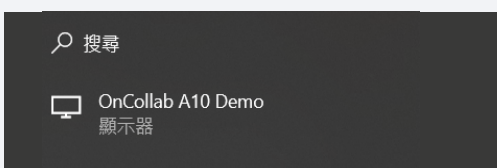

2

Select the OnCollab A10 you want to project to

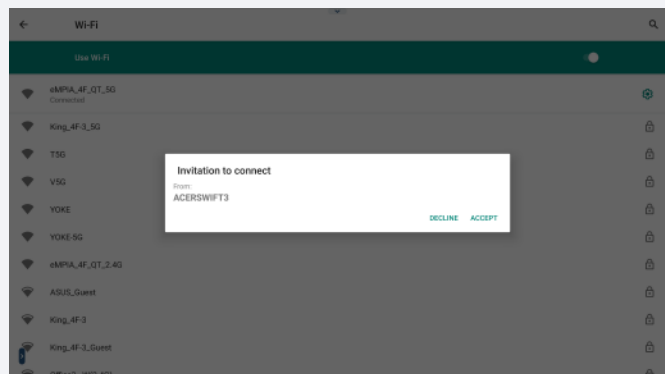

3

A confirmation message for the projection will appear. Click Accept to start projection.

* The projection confirmation message will only appear the first time you project using Miracast.

02

Projection Screen

1 User Currently Projecting

2 Status Bar and Login Code

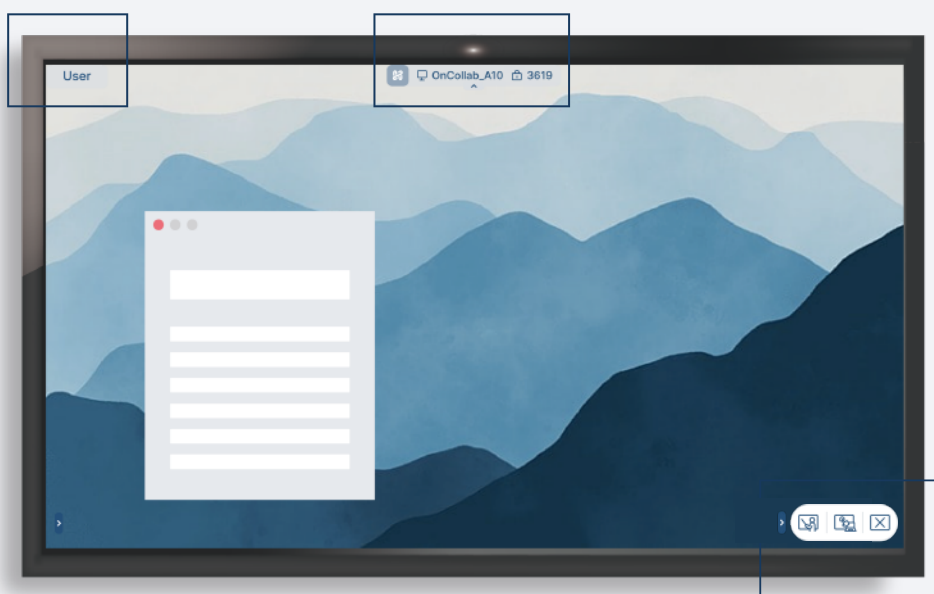

Click to Hide

1

2

3

Click to Show

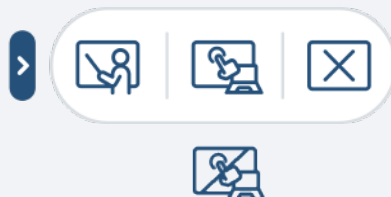

Description

- 1 Turn On/Off Moderator Mode
- 2 Turn On/Off Touchback Control
- 3 End Screen Projection

03

Screen Projection Settings

OnCollab A10 Supports Multiple Screen Projection

Screen Projection - Duplicate Screen Projection



Screen Projection - Extended Screen Projection

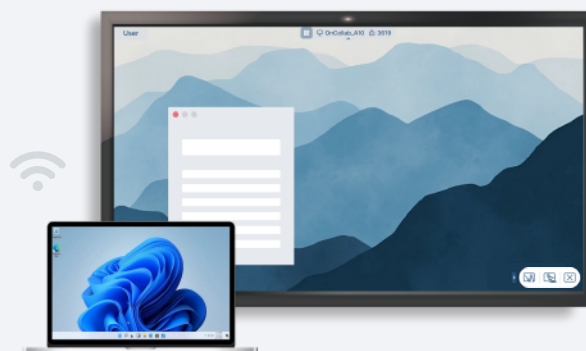

Screen Projection - Simultaneous 2 Screens Projection

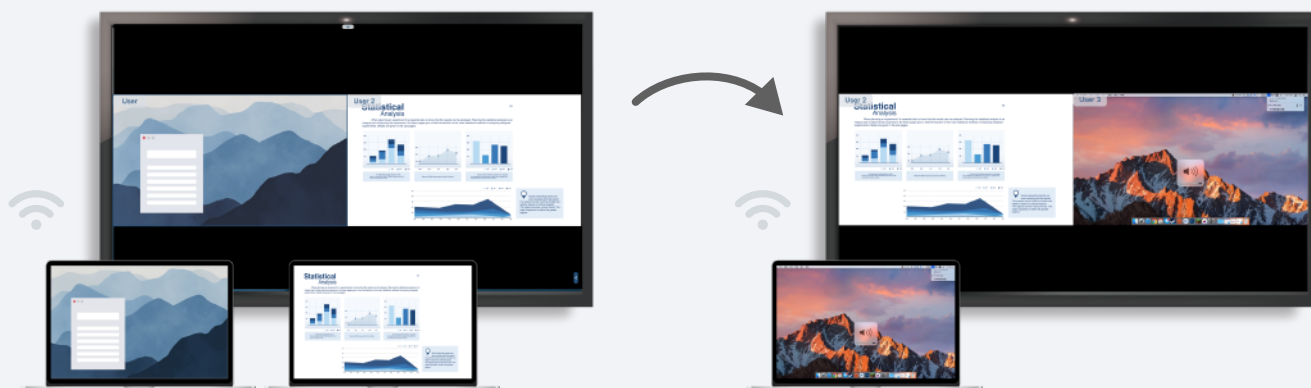

Allow 2 screens to be projected at the same time.

When the third screen is added to the projection, it replaces the screen that was first projected.

Screen Management



1

When there are multiple projections, tap one of them to display the “Maximize Screen” and “Close Screen” icons on the screen.

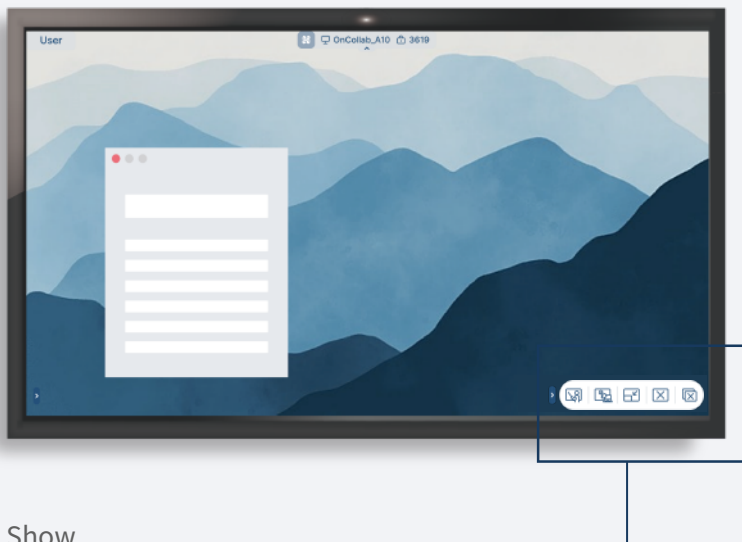

2

When one of the screens is displayed on the full screen, tap the screen again, and screen management bar will be displayed in the lower right corner of the screen.

Show
Screen Management Bar

Hide
Screen Management Bar

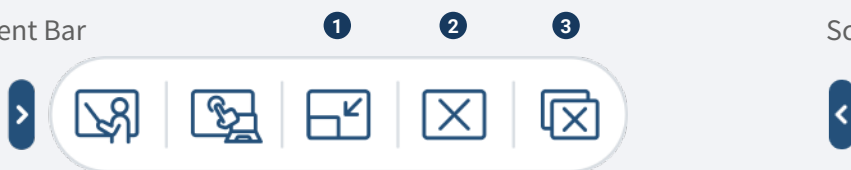

Description

- 1** Minimize Screen – Return to multi-screen view / Maximize Screen – Display in full screen
- 2** End - End Current Screen Projection
- 3** End All - End All Screen Projection

04 Touchback Control

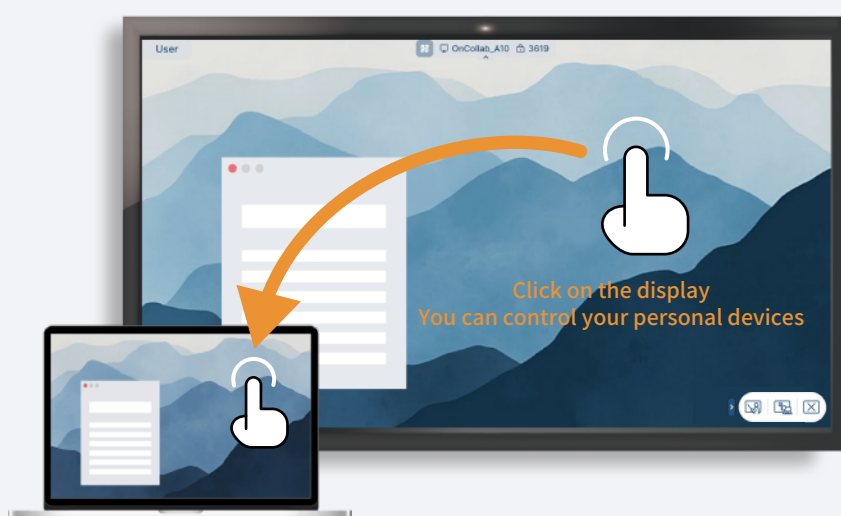

Control your personal device from the comfort of your screen using A10's Touchback Control. Tap your main screen to control, drag, and click your personal device such as your laptop.

This feature is currently only available when projecting your screen through AVACAST App in Windows and Mac.

05

OnCollab A10 Settings

Basic Settings

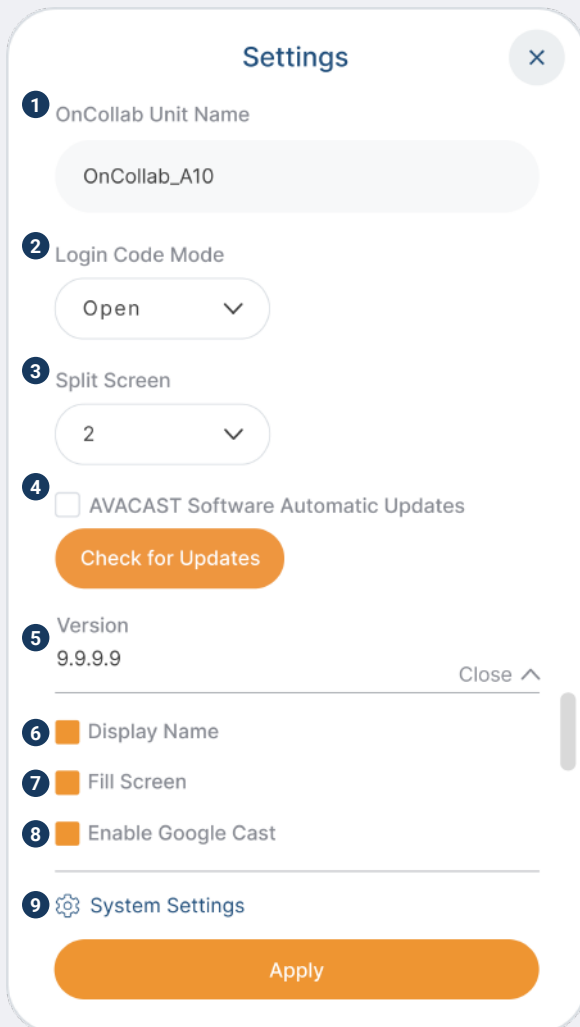

Description

- 1 Personalizable device name
- 2 On- Randomly generates a login code for each projection session
Off- No login code required
Custom login code- allows the user to set the login code
- 3 Sets the maximum amount of screens that can displayed simultaneously. Requires a restart
- 4 Option to enable or disable automatic software update
- 5 Shows current A10 firmware Version

- 6 Display the username of the current screen projector
- 7 Fill the projected image to a 16:9 screen
- 8 Enable/Disable Google Cast

- 9 Enter System Settings

06

Moderator Mode

In Moderator Control Mode, OnCollab A10 can directly control and manage the personal devices that are connected to it, allowing them to set and choose which device can project their screen. Casting from non-moderator users will be disabled in this mode.

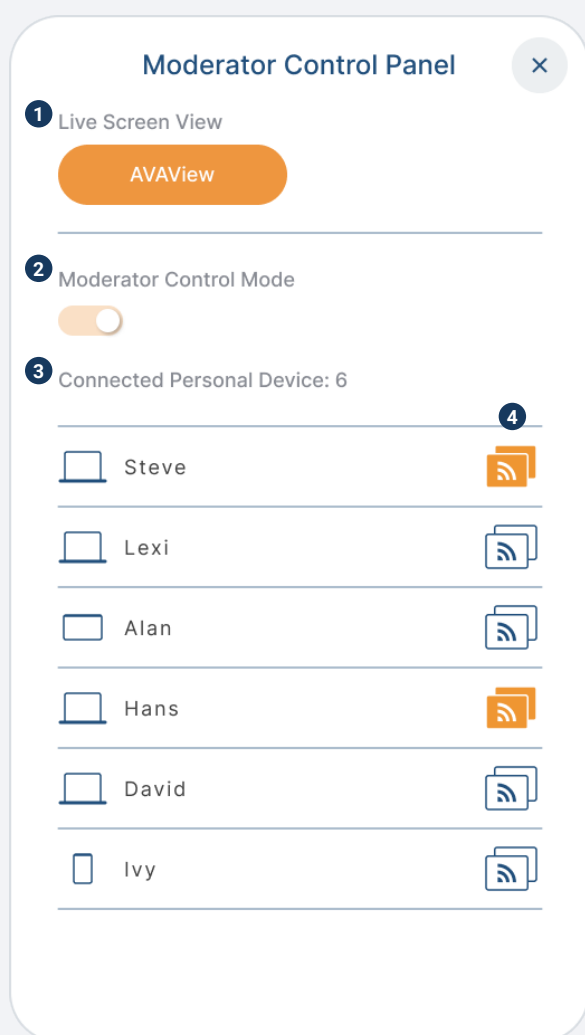

Description

- 1** AVAView - Other users on the same network can scan the QR code or enter the URL to view the current projected screen in real time.
- 2** Turn On/Off Moderator Mode
- 3** Displays the connected personal devices, and uses different icons to represent different device types
- 4** Click to select the personal device you want to cast to your screen

AVAView



When a user is casting, others on the same network can scan the QR code or enter the URL to view the projected screen via a browser

Screen Projection in Moderator Mode

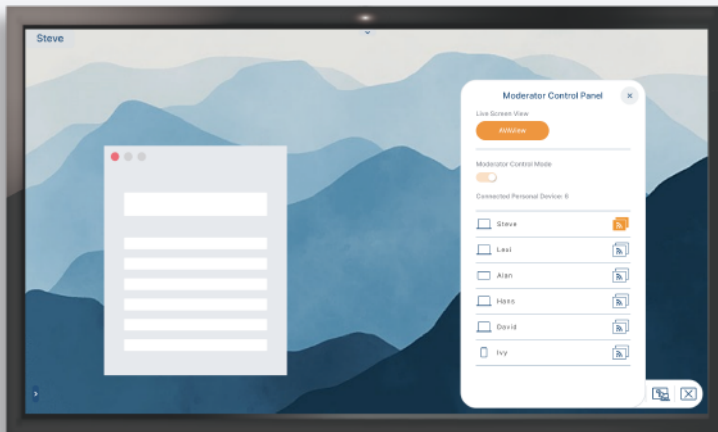

1

Click the lower right corner  to open the Moderator Control Panel, and then click the personal device you want to project to start the projection.

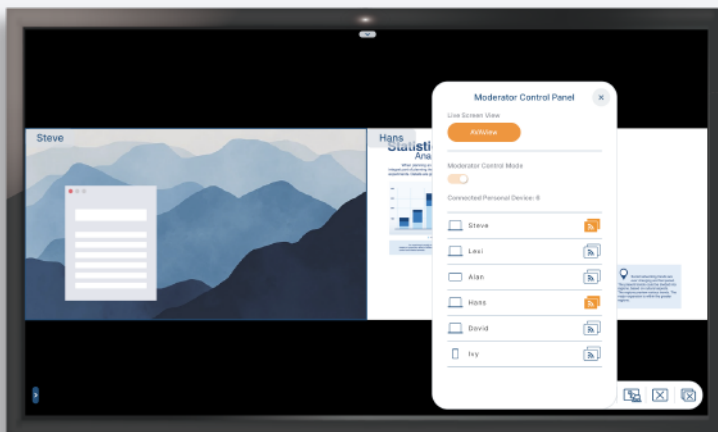

2

Simultaneous 2 screen projection is also supported in Moderator Mode.

* Casting via AirPlay and Google Cast is not supported in Moderator Mode.

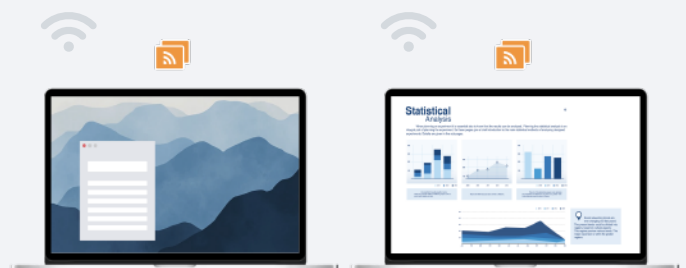

07

OnCollab MultiCast

OnCollab's MultiCast feature allows an OnCollab A10 to project its screen to other OnCollab devices.

This function is limited to screen sharing.

After the OnCollab MultiCast is turned on, it will display the list of other OnCollab devices currently connected.

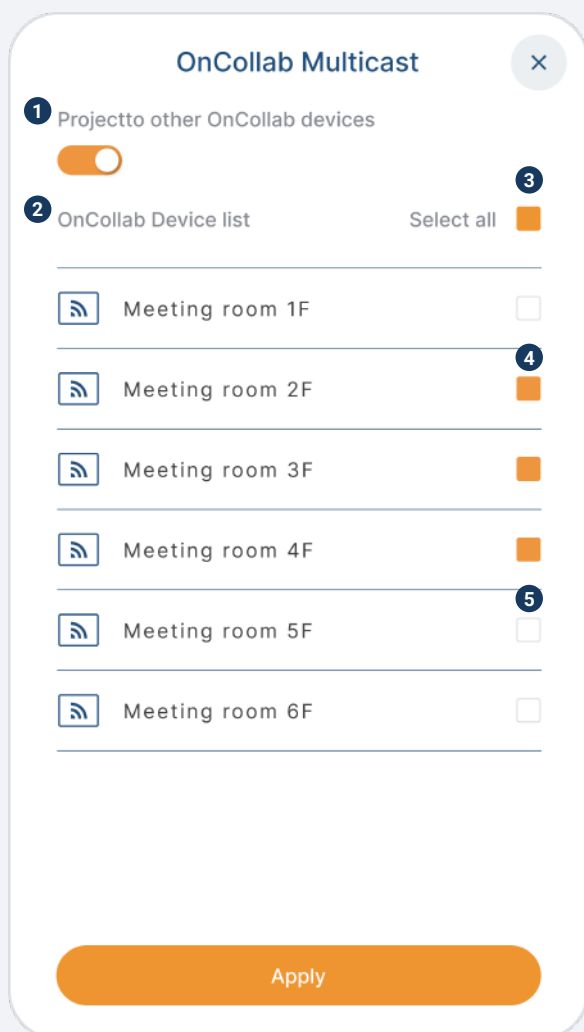

Description

- 1 Enable MultiCast mode
 - 2 Displays the OnCollab devices currently connected on the same network
 - 3 Select All to mirror the screen to all connected OnCollab devices
 - 4 Check the OnCollab devices you want to sync the screen with, then click Apply to start projection
 - 5 To stop screen mirroring, uncheck the selected devices and click Apply again
- You can also click  End Screen Projection on the other OnCollab devices screen.

MultiCast to other OnCollab devices.

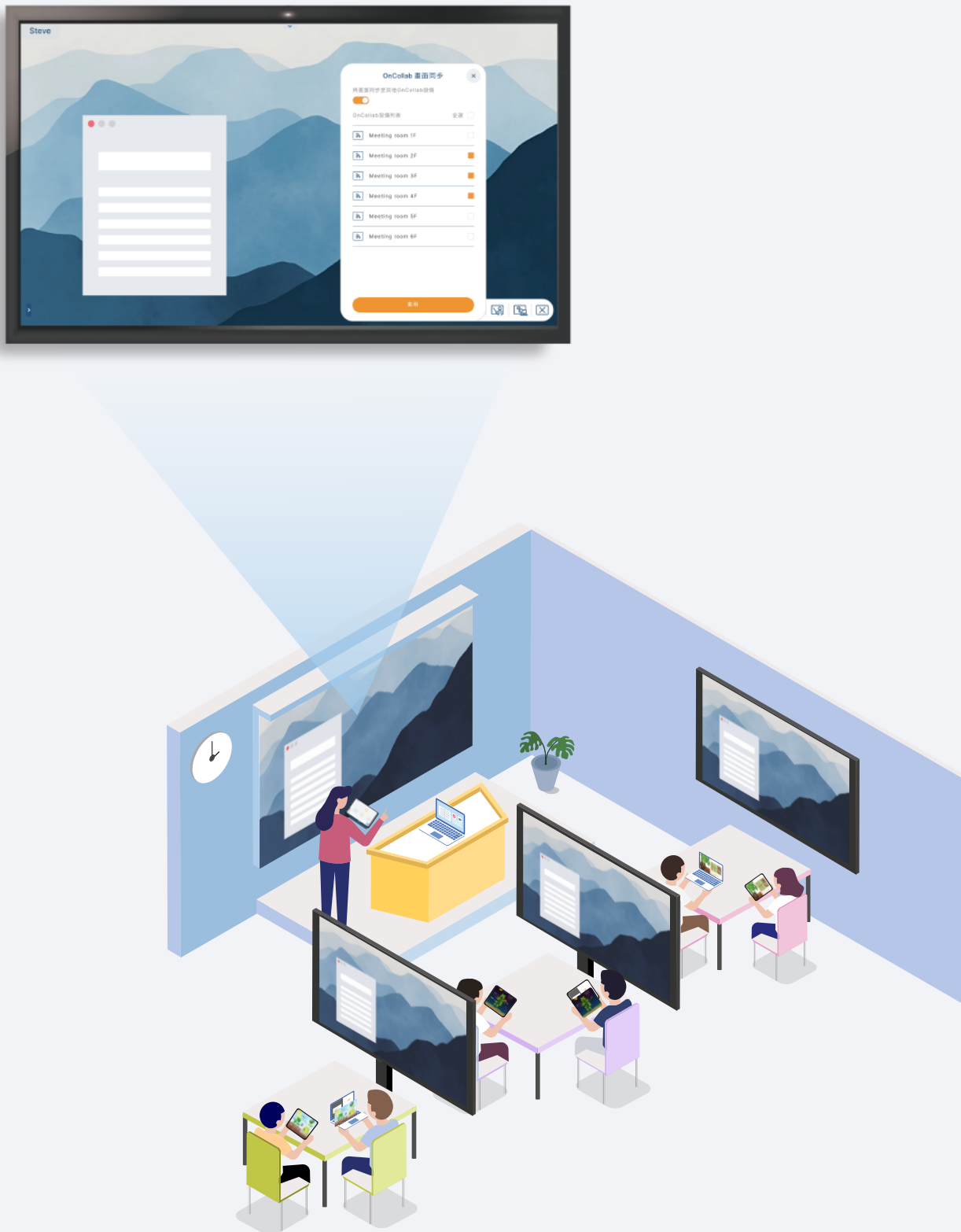

01



AVACAST Windows App

AVACAST Win TX



Install AVACAST App on Windows

You can install AVACAST App on Windows by following the steps below.

1

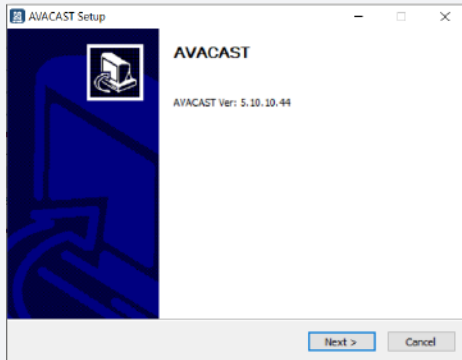

2

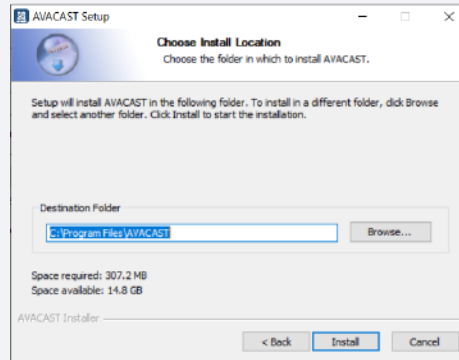

3

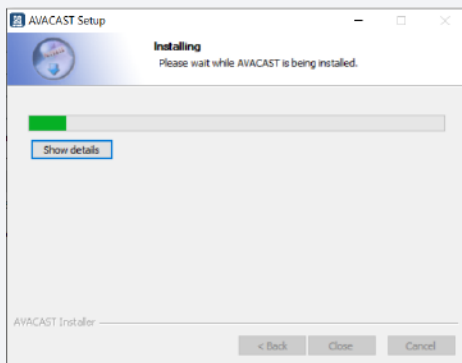

4

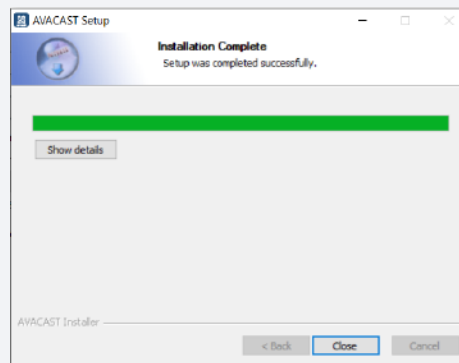

Opening AVACAST Windows



1 Pairing with OnCollab A10

The device needs to be connected to the same network as OnCollab A10 to project. If your device and A10 is both on the same network, A10 will automatically display your device's username on the standby screen.

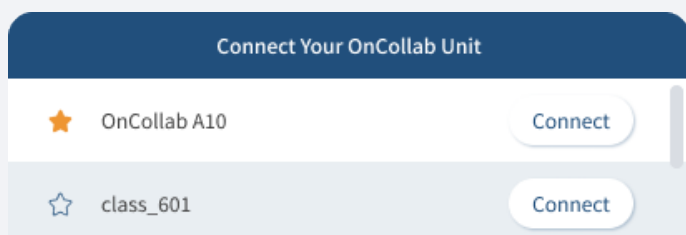

2 Setting a Favorite Device

Select the device you want to set as your favorite and click the star icon to the left of the device name. That device will now always be displayed on the top of the list, if available on the same network.

3 Connecting to OnCollab A10

1 Method 1

Select the OnCollab A10 you want to project to and press Connect.

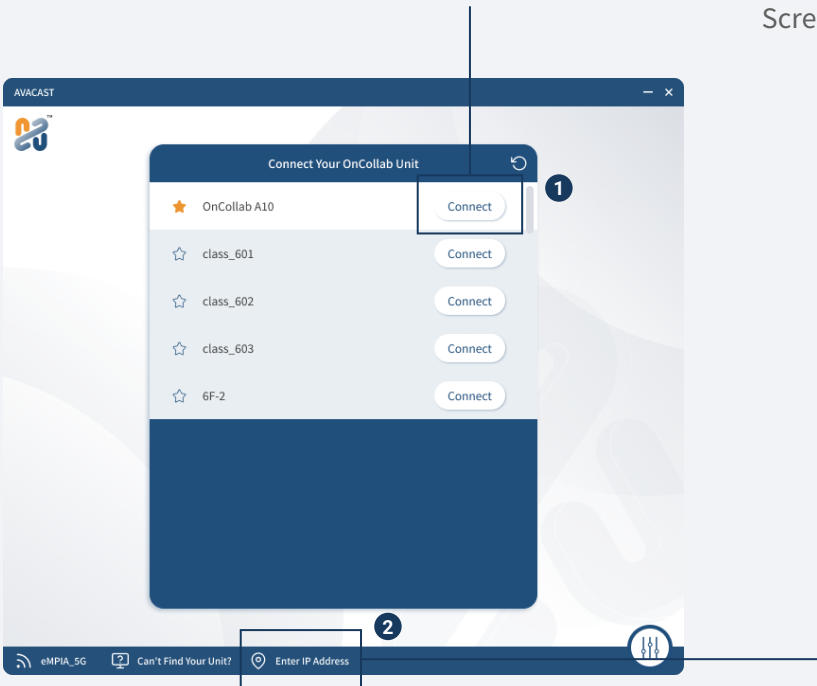

2 Method2

In some cases, your device and OnCollab A10 are on different segments of the same network. You can fix this by entering the IP address displayed on the Standby Screen in your AVACAST App.

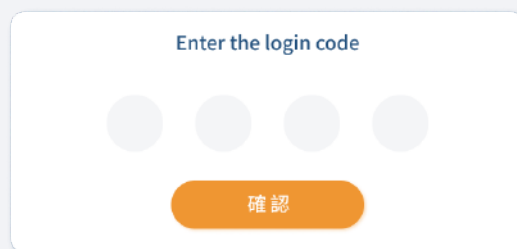

Enter the login code to pair with OnCollab A10.
Now you are able to project or use the wireless conferencing feature.

AVACAST Windows App User Interface

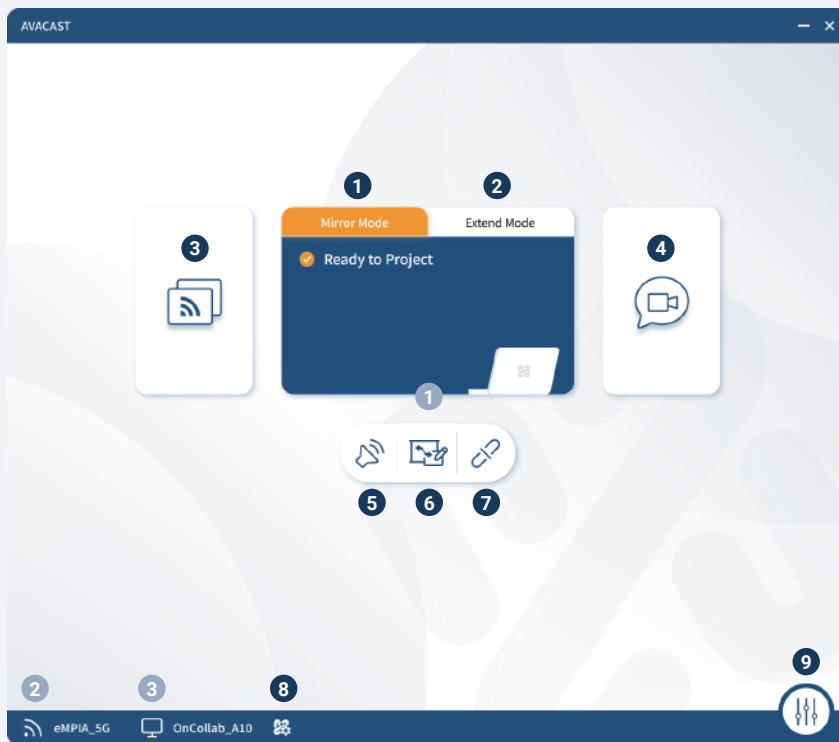

Functional Items

- 1 Duplicate Screen Projection
- 2 Extend screen projection
- 3 Project
- 4 BYOM
- 5 Volume Control
- 6 Dual direction control
- 7 Disconnect
- 8 Add to AMS
- 9 Settings

Description

Choose this option to duplicate and project your current screen

Choose this option to extend and project your current screen

Start Projection

Enable usage of webcam and/or speakerphones connected to A10

If BYOM is enabled is connected, control the volume of conference devices connected to A10. Otherwise controls the volume of your device

You can control the main screen from your device, and enable sharing notes

Disconnect from the OnCollab A10 and return to the connection screen

Add your OnCollab A10 Unit to our AMS (AVA Management System), where it can be managed remotely

General/Help/About

Display Information

- 1 Status Bar
- 2 Currently Connected Network
- 3 Connected Devices

Description

Display the status of AVACAST transmitter and receiver

Shows the current network

Display currently connected OnCollab A10 Unit

Screen Projection



1 Projection – AVANote

AVANote can also be used while projecting. The AVANote toolbar will be displayed on the right side of your device screen as soon as you start projecting. The AVANote can be used to draw and make notes while projecting, and the projected image will be displayed on the large screen along with the notes that you're making.



By default, the toolbar is open and can be closed by clicking 



Click on the icon to expand the toolbar

Toolbar Descriptions

- 1 Default Mode -
Use your touchscreen or mouse to control
- 2 Annotation Mode -
Default color is orange. You can draw and take notes on your screen
- 3 Undo Button -
Reverse the last action
- 4 Delete Annotation -
Delete all drawings from the screen
- 5 Screenshot and copy current screen
- 6 Screenshot and share current screen

Dual Direction Control



Click on the button in AVACAST App to open a dual direction window. You cannot project your screen while dual direction is enabled.



The dual direction control allows you to project the screen of OnCollab A10 back to the your personal device. You can then control OnCollab A10 or make on-screen annotations through your personal device. There are two modes, CollabSpot and AVANote, and the detailed functions are as follows:

1 CollabSpot

The drawing and annotations of each personal device can be displayed simultaneously on the large screen, allowing multiple users to collaborate at the same time. User on the main screen can also participate at the same time. CollabSpot is not available when Moderator Mode is enabled.



Click on the icon to expand the toolbar.



By default, the toolbar is open and can be closed by clicking 



Toolbar Descriptions

- 1** Default Mode - Use your touchscreen or mouse to control
- 2** Draw Mode - You can draw and share your annotations with others.
- 3** Undo Button - Reverse the last action
- 4** Delete Annotation - Delete all drawings from the screen
- 5** Screenshot and copy current screen.
- 6** Screenshot and share current screen



2 Touchback Control — AVANote

If you want to take notes on your own, tap this feature to make notes on your personal device in the two-way window, which does not appear on the big screen.



Click on the icon to expand the toolbar.



By default, the toolbar is open and can be closed by clicking 

Toolbar Descriptions

- 1 Annotation Mode - Default color is orange. You can draw and take notes on your screen
- 2 Undo Button - Reverse the last action
- 3 Delete Annotation - Delete all drawings from the screen
- 4 Screenshot and copy current screen
- 5 Screenshot and share current screen



BYOM

The wireless conferencing feature lets you connect your personal device remotely to the USB camera, speakerphones, and microphones attached to the OnCollab A10—just as if they were plugged directly into your computer.



1 Wireless Conferencing Devices

Connect the USB video conferencing device to the OnCollab A10's USB 3.0 port. When the gray color icons as shown on the bottom of the OnCollab A10 standby screen appears, it means that the OnCollab A10 has recognized the connected USB video conferencing devices.

Orange color means that it is currently being used by a user. Green color means speakerphone is occupied / Red is muted.

*The speakerphone can only be used by AVACAST when it has both speaker and microphone functions.

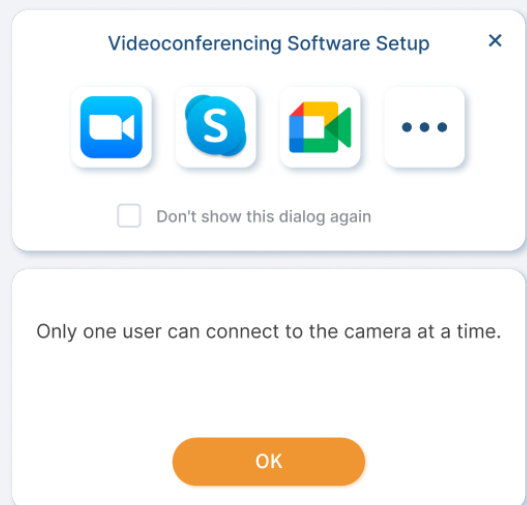

2 Video Conferencing Applications

Click on the AVACAST App, and your computer is now connected to the USB camera/speaker microphone. The first time you use this feature, AVACAST App will show you the instructions on how to set up the camera/speaker microphone in the video conferencing software.

If you check the box "Don't show again", then this instruction window will not be shown again. You can still see the instructions in the help section of the setting page.

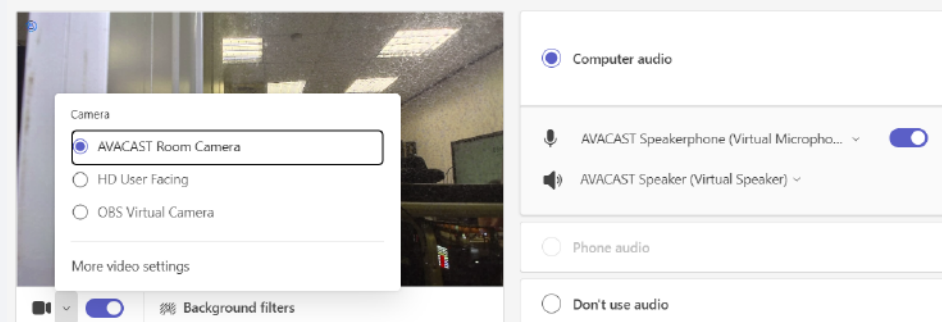

3 Application Settings

Next, go to "Audio and Video" within your video conferencing software to setup the USB camera/speaker microphone.

Using Teams as an example, set the camera to AVACAST Room Camera, and set the speakers & microphone to AVACAST Speakerphone.

4 Complete BYOM

Now you can start video conferencing with remote conference participants using your meeting rooms webcam and speakerphone.

Settings



Click to open the settings menu

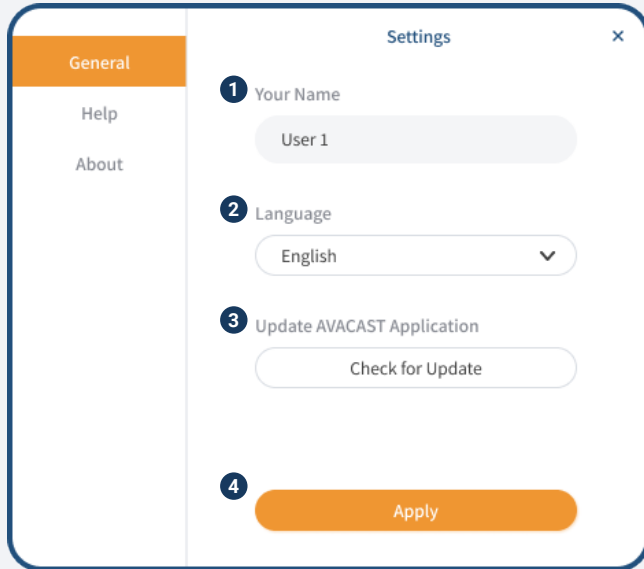

1 General

Descriptions

- 1 Set your device name
- 2 Set the language used by the AVACAST App
- 3 Check for AVACAST App Update
- 4 Apply the settings and close the settings menu

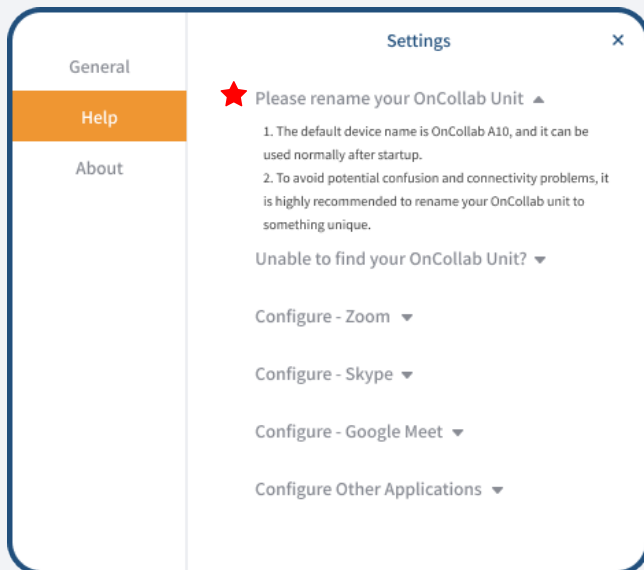

2 Help

Descriptions

- ★ The default device name is OnCollab A10, which can be used normally after power on. To avoid mistaking OnCollab devices with the same name when connecting to an OnCollab device, **users are recommended to change the OnCollab device name** to avoid operation or connection errors.

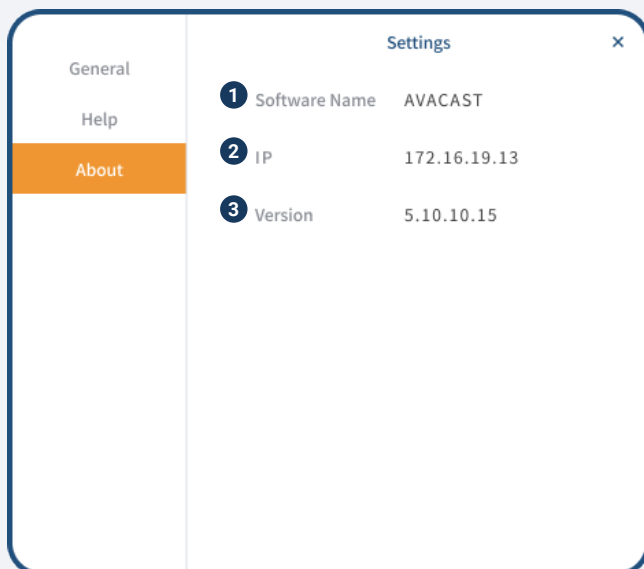

3 About

Descriptions

- 1 AVACAST
- 2 Display the IP of the current device
- 3 Show current AVACAST version

02



AVACAST Mac App

AVACAST Mac TX



Install AVACAST App on Mac

You can install AVACAST App on Mac by following the steps below.

1 Install AVACAST App

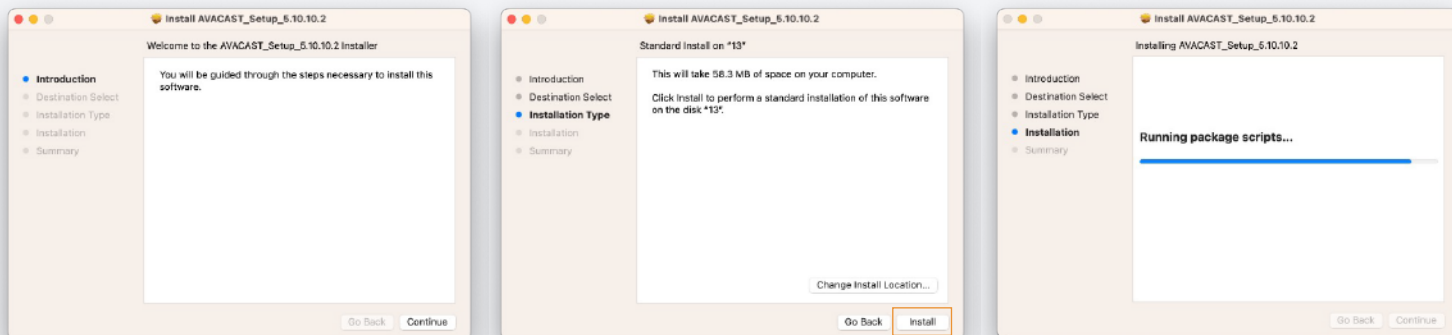

2 Install driver

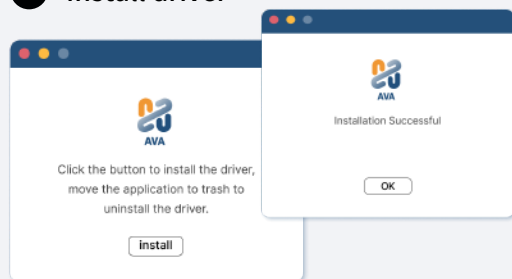

3 Open Security Preferences

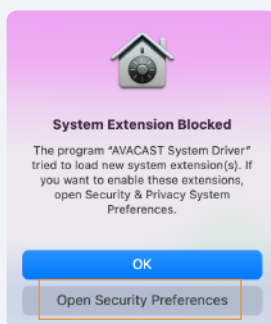

4 Details

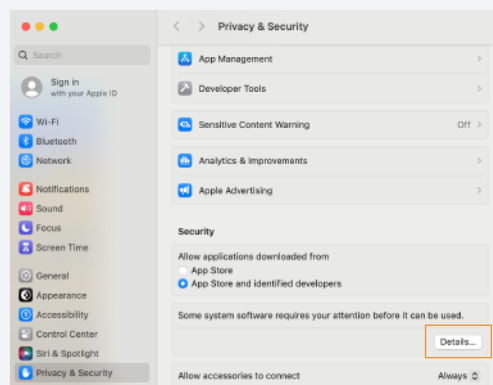

5 AVACAST System Driver Option Enable

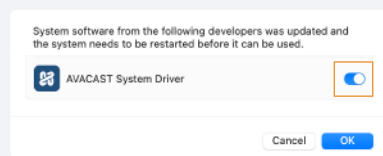

Opening AVACAST Mac



1 Pairing with OnCollab A10

The device needs to be connected to the same network as OnCollab A10 to project. If your device and A10 is both on the same network, A10 will automatically display your device's username on the standby screen.

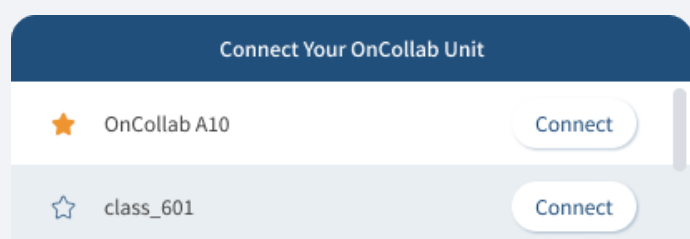

2 Setting a Favorite Device

Select the device you want to set as your favorite and click the star icon to the left of the device name. That device will now always be displayed on the top of the list, if available on the same network.

3 Connecting to OnCollab A10

1 Method 1

Select the OnCollab A10 you want to project to and press Connect.

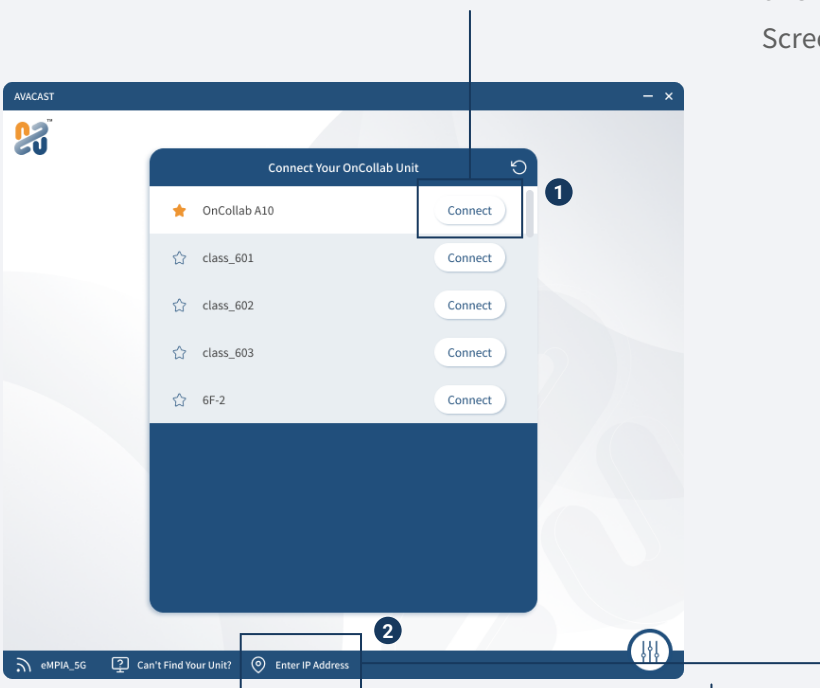

2 Method2

In some cases, your device and OnCollab A10 are on different segments of the same network. You can fix this by entering the IP address displayed on the Standby Screen in your AVACAST App.

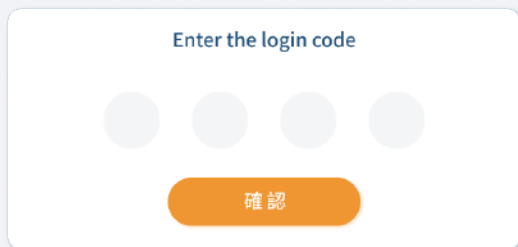

Enter the login code to pair with OnCollab A10. Now you are able to project or use the wireless conferencing feature.

4 Allow Projection Feature

When you use the projection function for the first time, please turn on the permission for screen recording, which can be set in Privacy and Security in the System Settings.

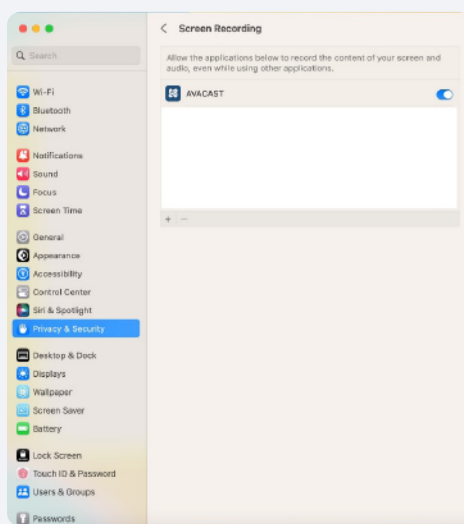

AVACAST Mac App User Interface

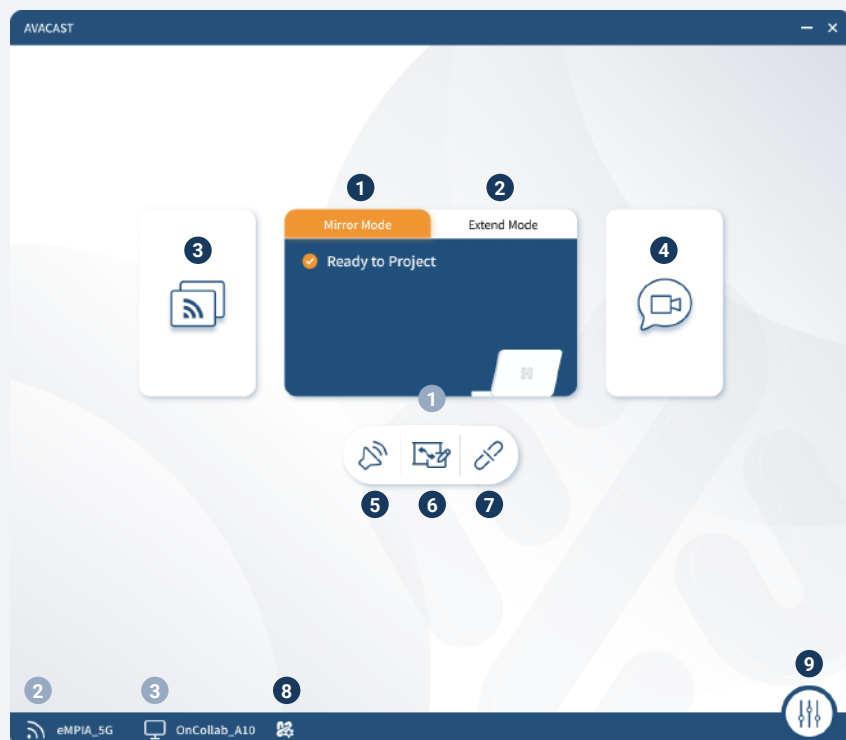

Functional Items

- 1 Duplicate Screen Projection
- 2 Extend screen projection
- 3 Project
- 4 BYOM
- 5 Volume Control
- 6 Dual direction control
- 7 Disconnect
- 8 Add to AMS
- 9 Settings

Description

Choose this option to duplicate and project your current screen

Choose this option to extend and project your current screen

Start Projection

Enable usage of webcam and/or speakerphones connected to A10

If BYOM is enabled is connected, control the volume of conference devices connected to A10. Otherwise controls the volume of your device

You can control the main screen from your device, and enable sharing notes

Disconnect from the OnCollab A10 and return to the connection screen

Add your OnCollab A10 Unit to our AMS (AVA Management System), where it can be managed remotely

General/Help/About

Display Information

- 1 Status Bar
- 2 Currently Connected Network
- 3 Connected Devices

Description

Display the status of AVACAST transmitter and receiver

Shows the current network

Display currently connected OnCollab A10 Unit

Screen Projection



1 Projection – AVANote

AVANote can also be used while projecting. The AVANote toolbar will be displayed on the right side of your device screen as soon as you start projecting. The AVANote can be used to draw and make notes while projecting, and the projected image will be displayed on the large screen along with the notes that you're making.



By default, the toolbar is open and can be closed by clicking 



Click on the icon to expand the toolbar

Toolbar Descriptions

- 1 Default Mode - Use your mouse to control
- 2 Annotation Mode - Default color is orange. You can draw and take notes on your screen
- 3 Undo Button - Reverse the last action
- 4 Delete Annotation - Delete all drawings from the screen
- 5 Screenshot and copy current screen
- 6 Screenshot and share current screen

Dual Direction Control



Click on the button in AVACAST App to open a dual direction window. You cannot project your screen while dual direction is enabled.



The dual direction control allows you to project the screen of OnCollab A10 back to the your personal device. You can then control OnCollab A10 or make on-screen annotations through your personal device. There are two modes, CollabSpot and AVANote, and the detailed functions are as follows:

1 CollabSpot

The drawing and annotations of each personal device can be displayed simultaneously on the large screen, allowing multiple users to collaborate at the same time. User on the main screen can also participate at the same time. CollabSpot is not available when Moderator Mode is enabled.



Click on the icon to expand the toolbar.



By default, the toolbar is open and can be closed by clicking 



Toolbar Descriptions

- 1** Default Mode - Use your touchscreen or mouse to control
- 2** Draw Mode - You can draw and share your annotations with others.
- 3** Undo Button - Reverse the last action
- 4** Delete Annotation - Delete all drawings from the screen
- 5** Screenshot and copy current screen.
- 6** Screenshot and share current screen



2 Touchback Control — AVANote

If you want to take notes on your own, tap this feature to make notes on your personal device in the two-way window, which does not appear on the big screen.



Click on the icon to expand the toolbar.



By default, the toolbar is open and can be closed by clicking 

Toolbar Descriptions

- 1 Annotation Mode - Default color is orange. You can draw and take notes on your screen
- 2 Undo Button - Reverse the last action
- 3 Delete Annotation - Delete all drawings from the screen
- 4 Screenshot and copy current screen
- 5 Screenshot and share current screen



BYOM

The wireless conferencing feature lets you connect your personal device remotely to the USB camera, speakerphones, and microphones attached to the OnCollab A10—just as if they were plugged directly into your computer.



1 Wireless Conferencing Devices

Connect the USB video conferencing device to the OnCollab A10's USB 3.0 port. When the gray color icons as shown on the bottom of the OnCollab A10 standby screen appears, it means that the OnCollab A10 has recognized the connected USB video conferencing devices.

Orange color means that it is currently being used by a user. Green color means speakerphone is occupied / Red is muted.

*The speakerphone can only be used by AVACAST when it has both speaker and microphone functions.

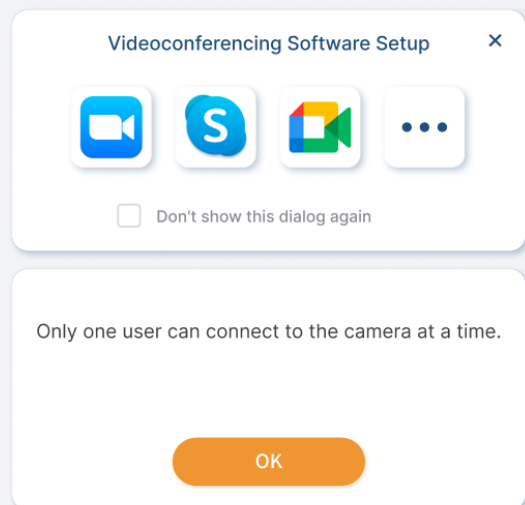

2 Video Conferencing Applications

 Click on the AVACAST App, and your computer is now connected to the USB camera/speaker microphone. The first time you use this feature, AVACAST App will show you the instructions on how to set up the camera/speaker microphone in the video conferencing software.

If you check the box "Don't show again", then this instruction window will not be shown again. You can still see the instructions in the help section of the setting page.

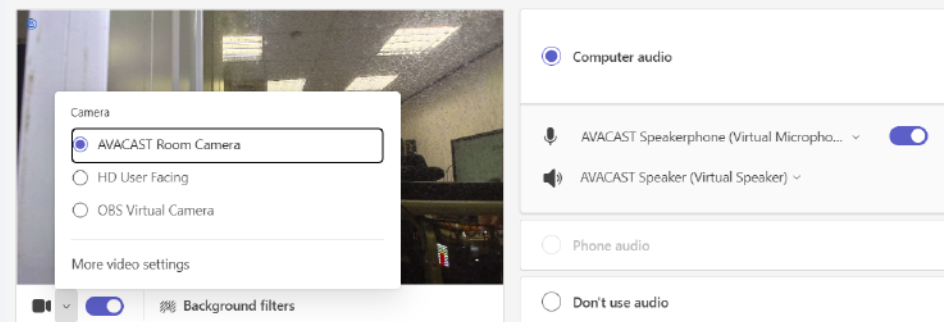

3 Application Settings

Next, go to "Audio and Video" within your video conferencing software to setup the USB camera/speaker microphone.

Using Teams as an example, set the camera to AVACAST Room Camera, and set the speakers & microphone to AVACAST Speakerphone.

4 Complete BYOM

Now you can start video conferencing with remote conference participants using your meeting rooms webcam and speakerphone.

Settings



Click to open the settings menu

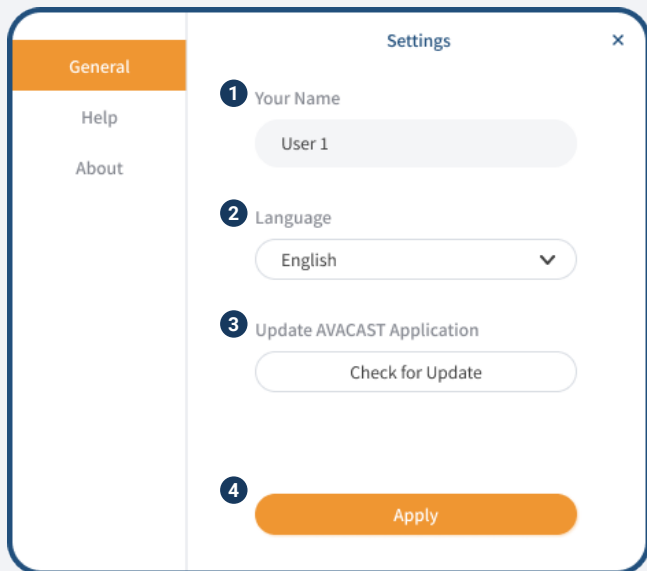

1 General

Descriptions

- 1 Set your device name
- 2 Set the language used by the AVACAST App
- 3 Check for AVACAST App Update
- 4 Apply the settings and close the settings menu

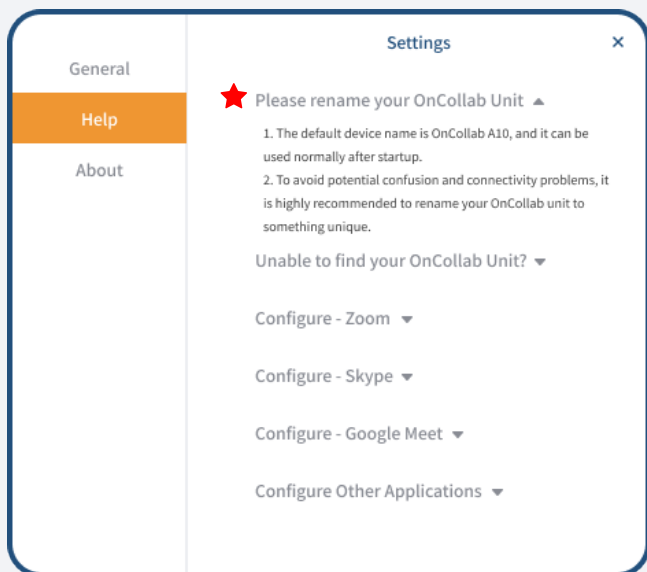

2 Help

Descriptions

- ★ The default device name is OnCollab A10, which can be used normally after power on. To avoid mistaking OnCollab devices with the same name when connecting to an OnCollab device, **users are recommended to change the OnCollab device name** to avoid operation or connection errors.

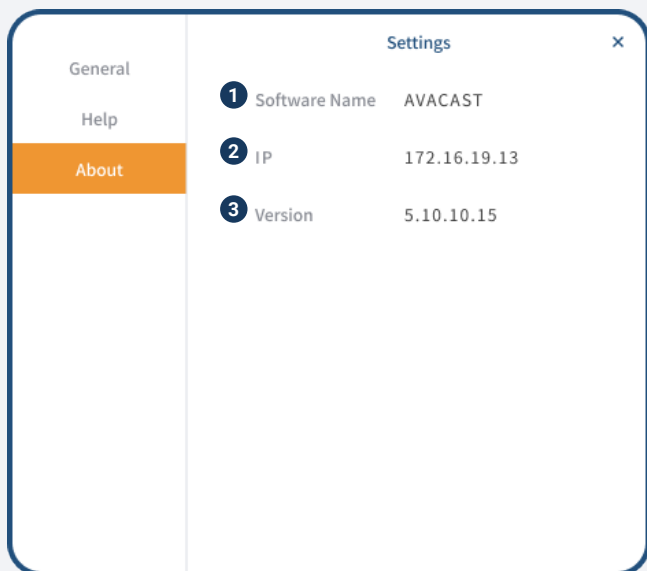

3 About

Descriptions

- 1 AVACAST
- 2 Display the IP of the current device
- 3 Show current AVACAST version

03



AVACAST Android App

AVACAST Android TX

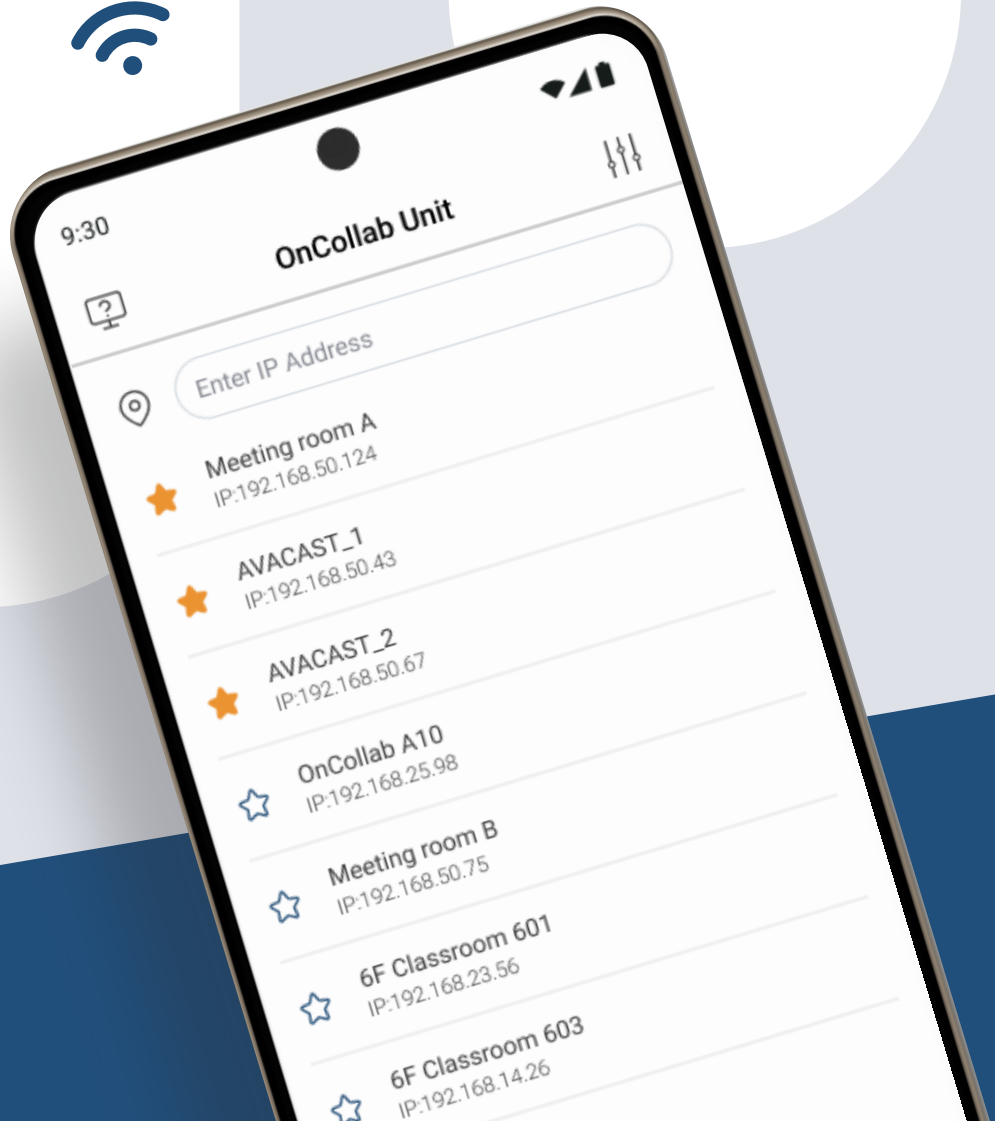

Install AVACAST App on Android

1 Install

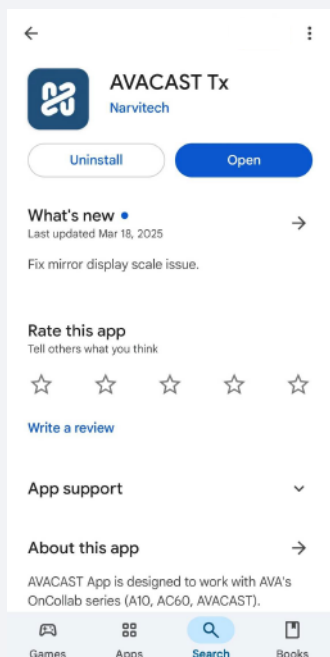

Download and install AVACAST App on Android Projection Software by downloading from Google Play or installing directly from APK file.

 Google Play link:



2 Connect

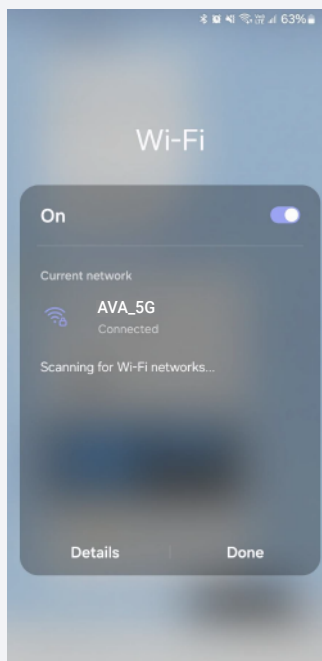

Make sure your device is connected to the same network as the OnCollab A10 before you begin.

Opening AVACAST Android

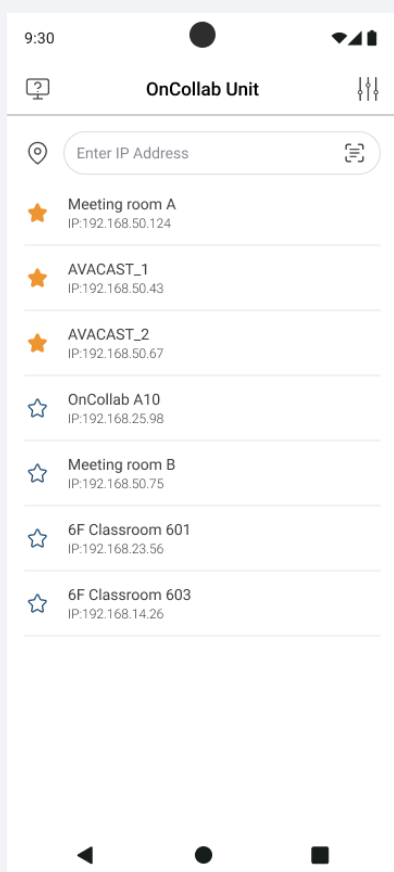

1 Set OnCollab A10 as a Favorite Device

Select the OnCollab A10 you want to mark as a favorite, then tap the star icon next to its name. Once set as a favorite, this OnCollab A10 will appear at the top of the list when AVACAST detects it.

2 Pair with OnCollab A10

Select the OnCollab A10 unit you want to pair with.

3 Find OnCollab A10 via IP

If your personal device and the OnCollab A10 are on the same network but different subnets, you can manually enter the OnCollab A10's IP address to pair.

- 1 Click the scan icon on the right side of the "Enter IP Address" field.

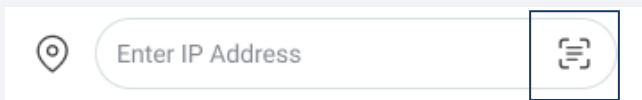

- 2 Scan the QR code located below the IP address on the standby screen.



- 3 Once connected, you will be taken to the standby screen before projection begins.

5 Application Permission

When you see the following message, please select Start now.

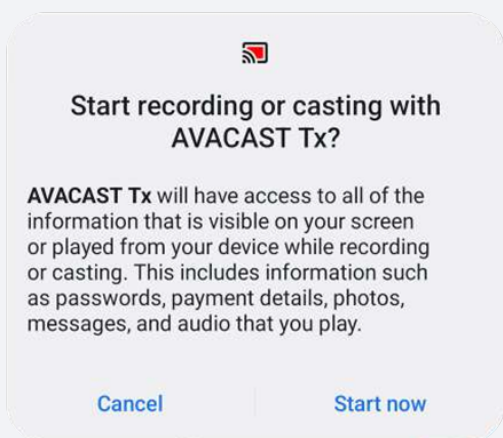

4 Connecting to OnCollab A10

You can connect by either entering the login code directly or manually entering the IP address.

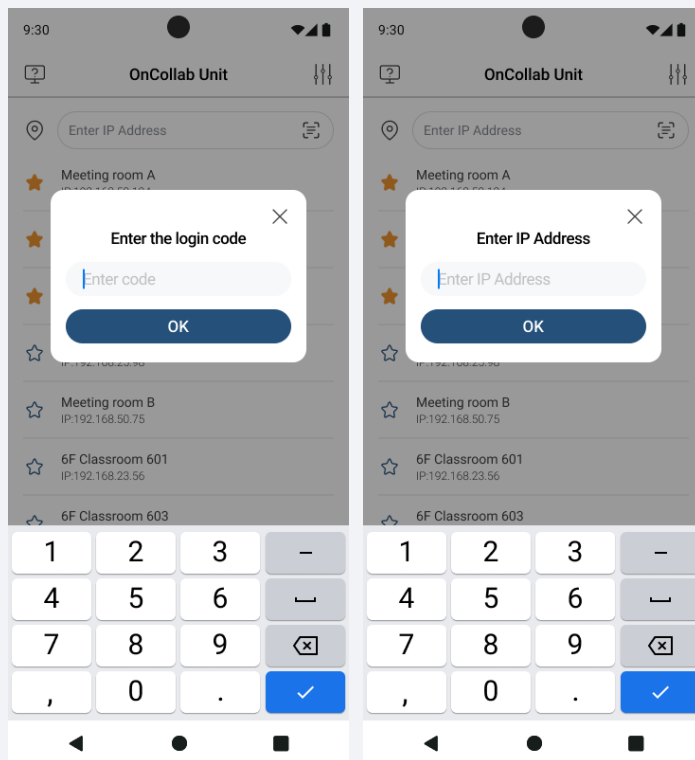

6 Projection

Press Projection  to start projecting your screen.

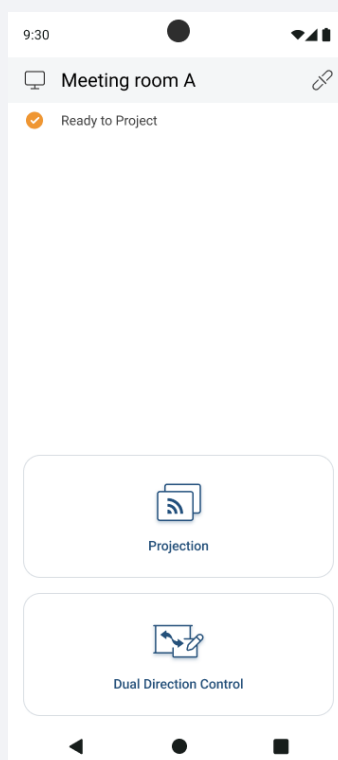



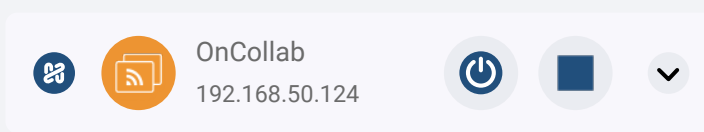
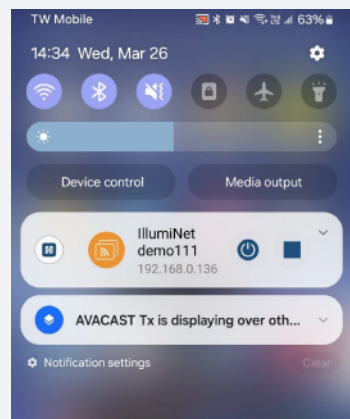

Notification Bar Control Panel Guide

1 Notification Bar Features

Swipe down from the top of the screen to open the notification bar.



Icon	Description
1  / 	Start/Stop casting
2 	Close AVACAST App

Display Information	Description
1 	Status icon that indicates the app is running
2 OnCollab Unit	Show the name of the connected OnCollab A10 Unit
3 IP	Show the IP address of the connected OnCollab A10 Unit

Dual Direction Control



Click on the button in AVACAST App to open a dual direction window. You cannot project your screen while dual direction is enabled.

The dual direction control allows you to project the screen of OnCollab A10 back to the your personal device. You can then control OnCollab A10 or make on-screen annotations through your personal device. There are two modes, CollabSpot and AVANote, and the detailed functions are as follows:

1 CollabSpot

The drawing and annotations of each personal device can be displayed simultaneously on the large screen, allowing multiple users to collaborate at the same time. User on the main screen can also participate at the same time. CollabSpot is not available when Moderator Mode is enabled.

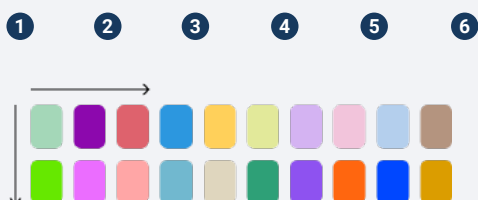
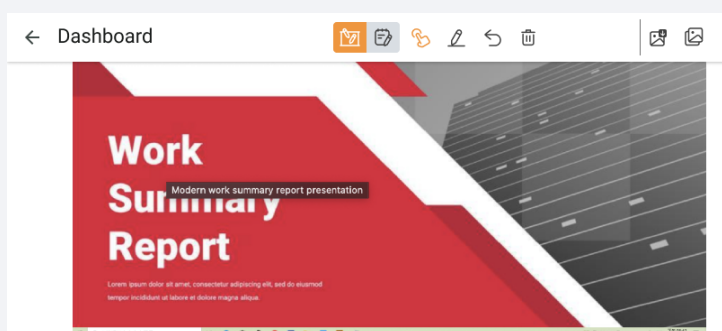

Maximum of 20 simultaneous CollabSpot users.

Toolbar Descriptions

- 1 Default Mode - Use your touchscreen or mouse to control
- 2 Draw Mode - You can draw and share your annotations with others.
- 3 Undo Button - Reverse the last action
- 4 Delete Annotation - Delete all drawings from the screen
- 5 Screenshot and copy current screen.
- 6 Screenshot and share current screen

2 Touchback Control — AVANote

If you want to take notes on your own, tap this feature to make notes on your personal device in the two-way window, which does not appear on OnCollab A10's screen.

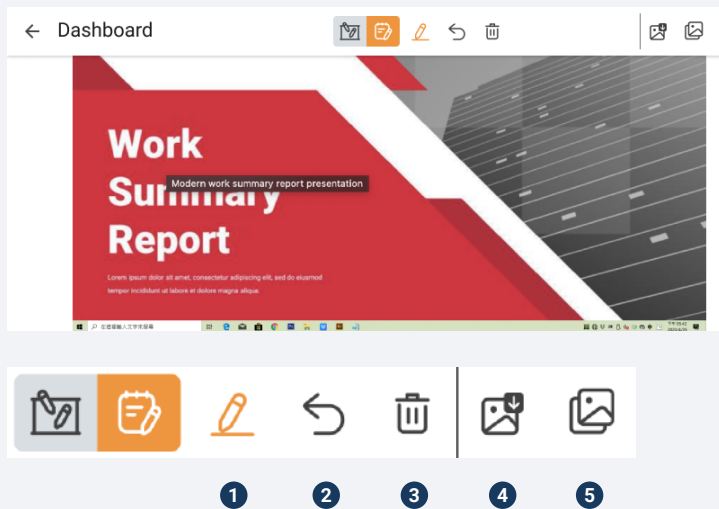

Toolbar Descriptions

- 1 Annotation Mode - Default color is orange. You can draw and take notes on your screen
- 2 Undo Button - Reverse the last action
- 3 Delete Annotation - Delete all drawings from the screen
- 4 Screenshot and copy current screen
- 5 Screenshot and share current screen

Settings

Before you start casting, you can press to open setting page and change your personal device's name.

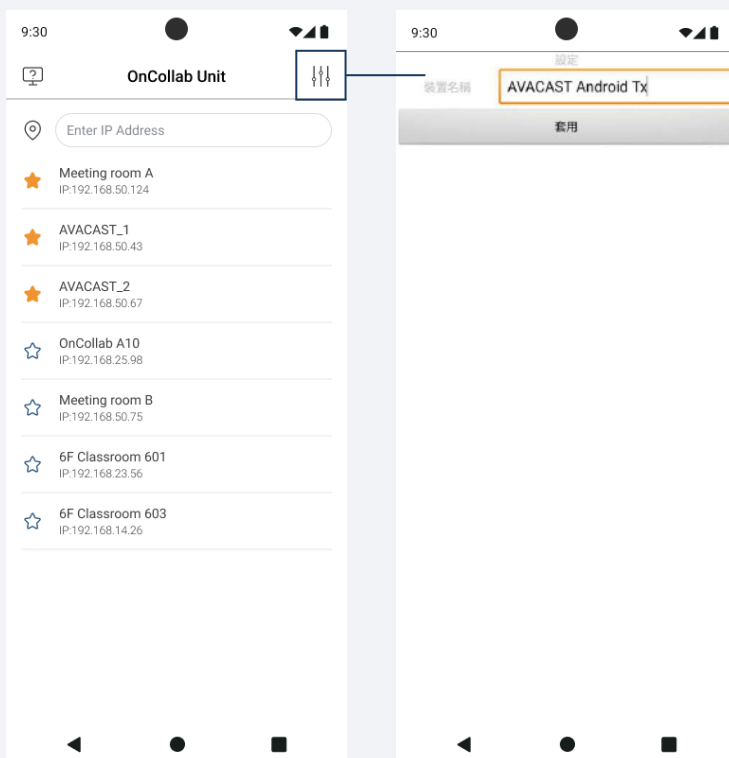

04



AVACAST iOS/iPadOS App

AVACAST iOS/iPadOS TX

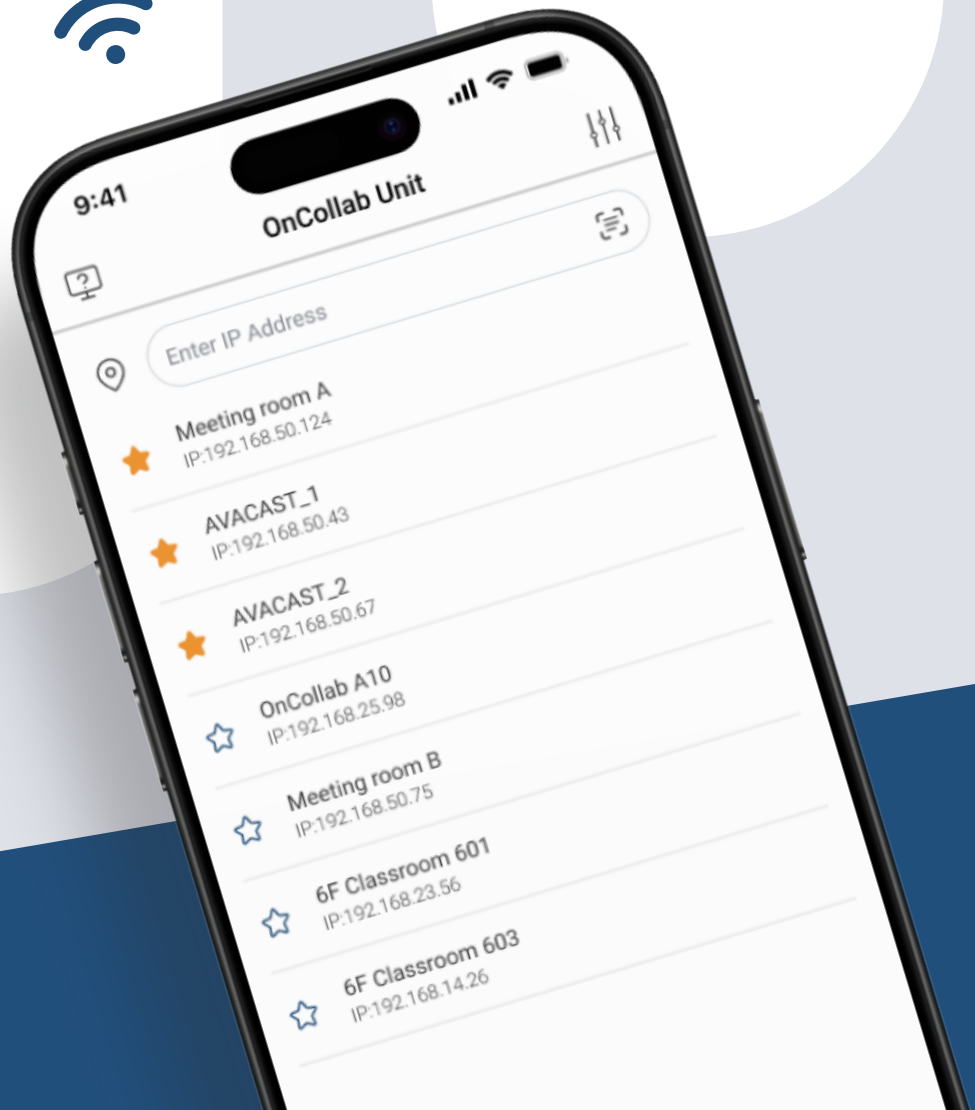

Install AVACAST App on iOS/iPadOS

1 Install

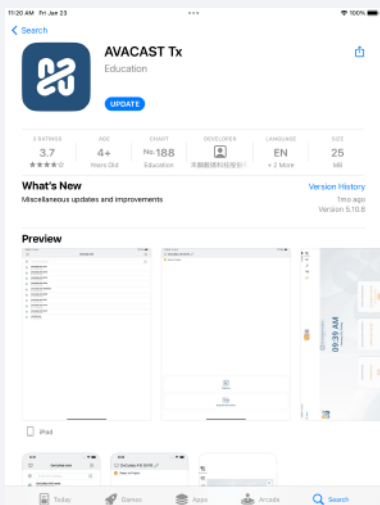

You can install AVACAST App on iOS/iPadOS by downloading from App Store.

App Store Link :



2 Connect

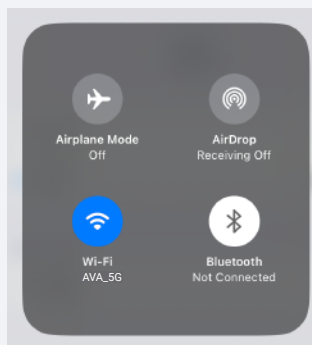

Make sure your device is connected to the same network as the OnCollab A10 before you begin.

Opening AVACAST iOS/iPadOS

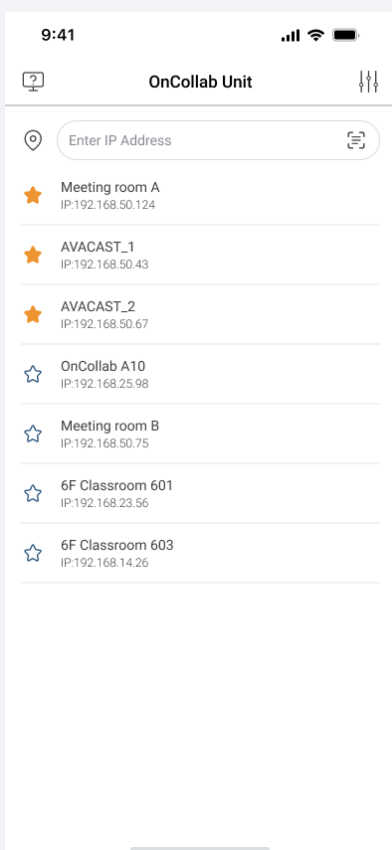

1 Set OnCollab A10 as a Favorite Device

Select the OnCollab A10 you want to mark as a favorite, then tap the star icon next to its name. Once set as a favorite, this OnCollab A10 will appear at the top of the list when AVACAST detects it.

2 Pair with OnCollab A10

Select the OnCollab A10 unit you want to pair with.

3 Find OnCollab A10 via IP

If your personal device and the OnCollab A10 are on the same network but different subnets, you can manually enter the OnCollab A10's IP address to pair.

- 1 Click the scan icon on the right side of the "Enter IP Address" field.

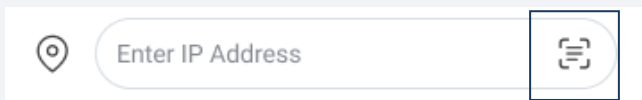

- 2 Scan the QR code located below the IP address on the standby screen.



- 3 Once connected, you will be taken to the standby screen before projection begins.

5 Projection

Tap Projection , then in the live stream window on the screen, click Start Streaming. Once the countdown finishes, the projection will begin.

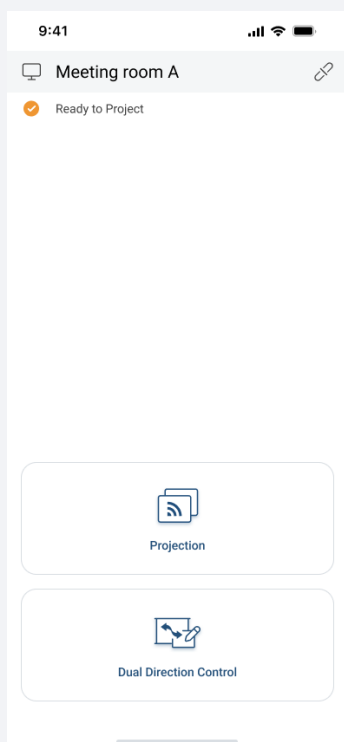

4 Connecting to OnCollab A10

You can connect by either entering the login code directly or manually entering the IP address.

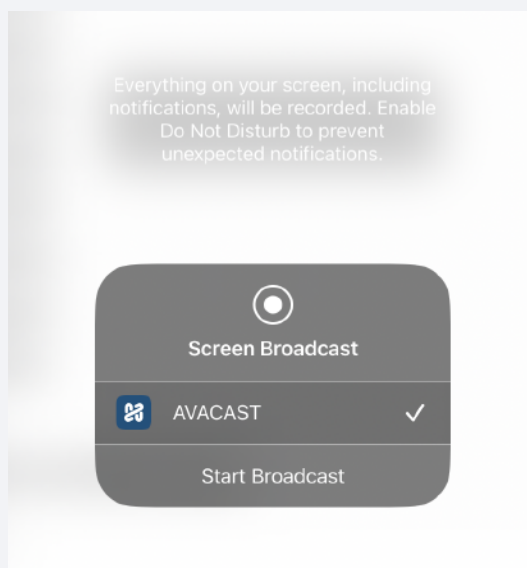
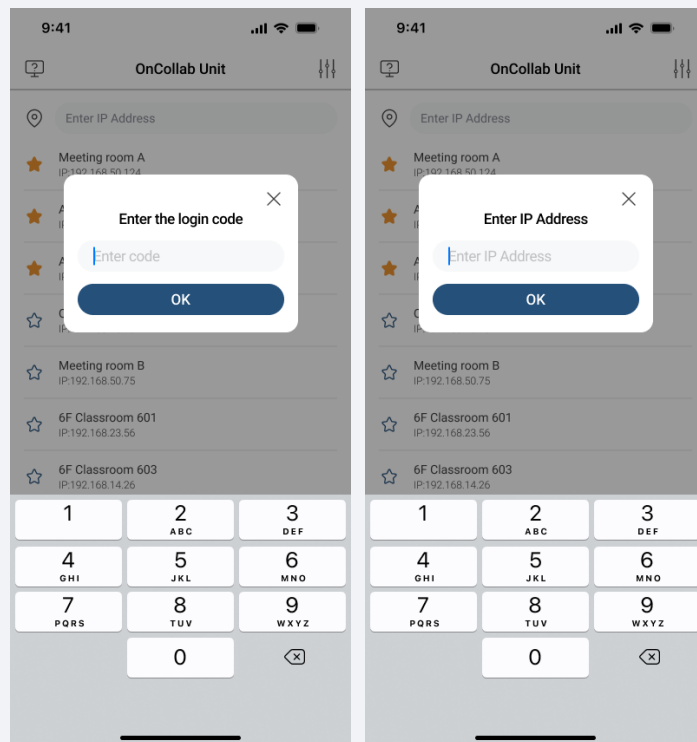

6 Stop Projection

To stop the projection , tap Stop again, or on iOS/iPadOS, tap the red live stream icon in the top right corner and select Stop.

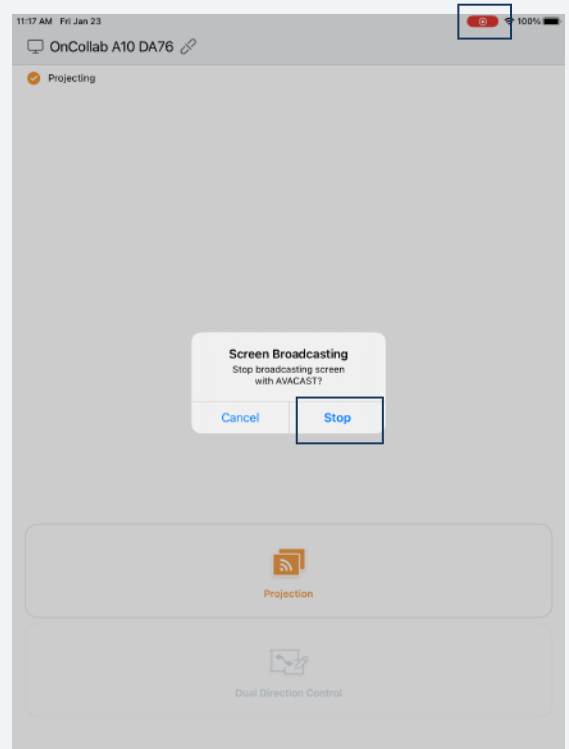

Dual Direction Control



Click on the button in AVACAST App to open a dual direction window. You cannot project your screen while dual direction is enabled.

The dual direction control allows you to project the screen of OnCollab A10 back to the your personal device. You can then control OnCollab A10 or make on-screen annotations through your personal device. There are two modes, CollabSpot and AVANote, and the detailed functions are as follows:

1 CollabSpot

The drawing and annotations of each personal device can be displayed simultaneously on the large screen, allowing multiple users to collaborate at the same time. User on the main screen can also participate at the same time. CollabSpot is not available when Moderator Mode is enabled.

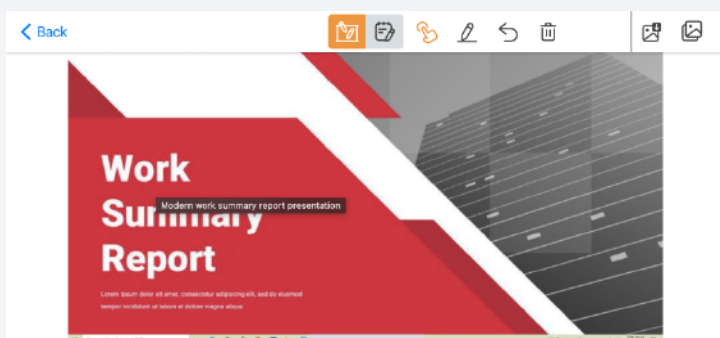

Maximum of 20 simultaneous CollabSpot users.

Toolbar Descriptions

- 1 Default Mode -
Use your touchscreen or mouse to control
- 2 Draw Mode -
You can draw and share your annotations with others.
- 3 Undo Button -
Reverse the last action
- 4 Delete Annotation -
Delete all drawings from the screen
- 5 Screenshot and copy current screen.
- 6 Screenshot and share current screen

2 Touchback Control — AVANote

If you want to take notes on your own, tap this feature to make notes on your personal device in the two-way window, which does not appear on OnCollab A10's screen.

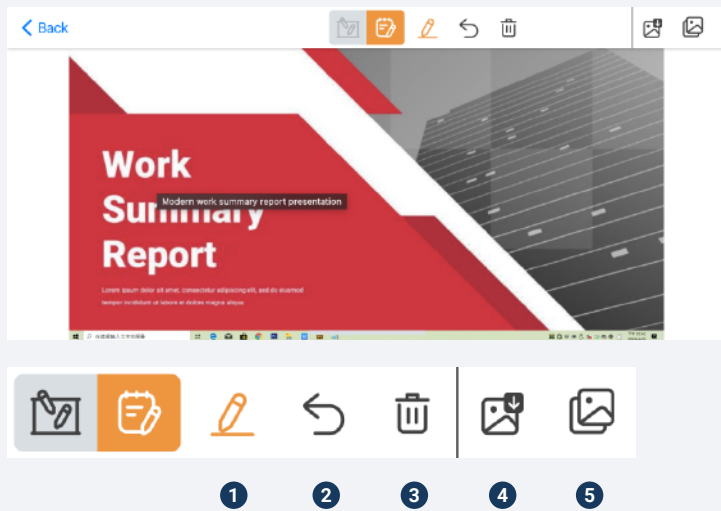

Toolbar Descriptions

- 1 Annotation Mode - Default color is orange. You can draw and take notes on your screen
- 2 Undo Button - Reverse the last action
- 3 Delete Annotation - Delete all drawings from the screen
- 4 Screenshot and copy current screen
- 5 Screenshot and share current screen

Settings

Before you start casting, you can press to open setting page and change your personal device's name.

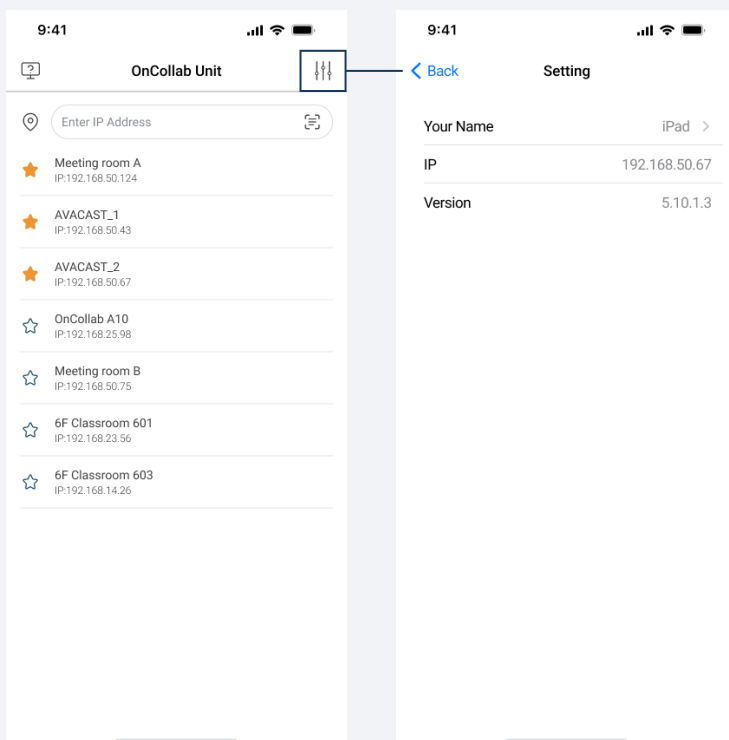

AVA
AVA
AVA

