

Your Castmate, Your Wireless Mate.

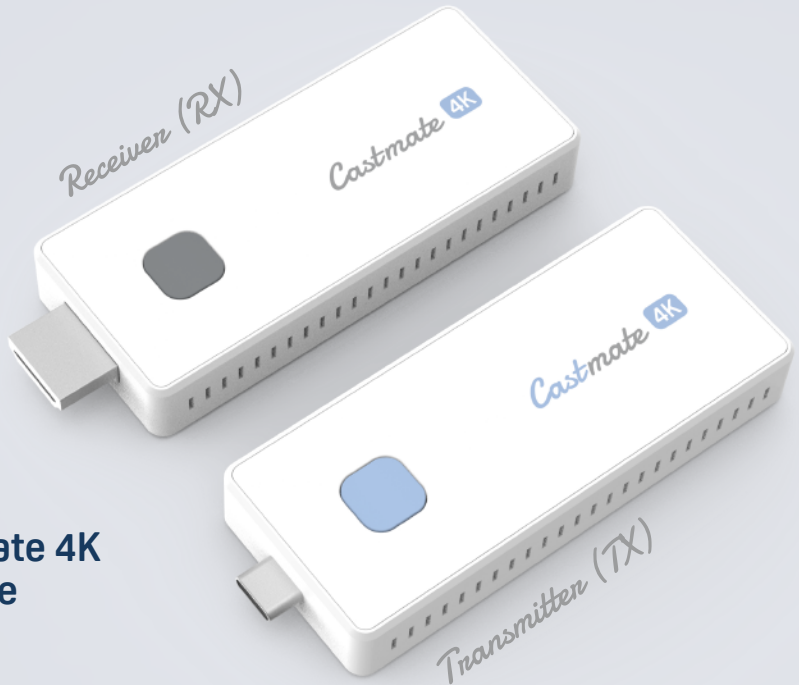

OnCollab Castmate 4K Quick Start Guide

AVA0CC4KQSG V2.0

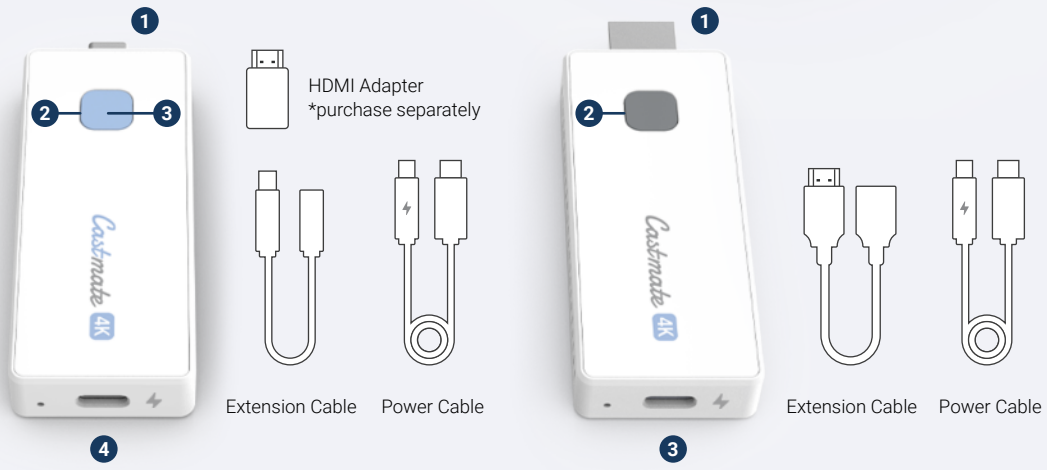

• Connections and Indicators

Transmitter (TX) - Blue

1. **USB-C In:** Connect with the USB-C port of the source device.
2. **LED Indicator:** Display current status.
3. **Connection Button:** Press to start screen sharing.
Press and hold for 4–5 seconds to repair TX and RX.
4. **USB-C port:** For TX power supply (DC 5V).

Receiver (RX) - Gray

1. **HDMI Output:** Connect with projector or monitor.
2. **LED Indicator:** Display current status.
3. **USB-C port:** For power supply (DC 5V).

• LED Indicators

● Red	TX unit is booting
● Flashing Red	TX unit is searching for RX unit
● Flashing Blue	Waiting for connection
● Blue	Connected
● Purple	No video input signal

● Flashing Blue	Waiting for connection
● Blue	Connected

• To Use Castmate 4K

1 Plug The Receiver (Gray)

Plug into the HDMI port of your TV, monitor, or projector.

2 Connect Power to The Receiver (Gray)

Use a USB-A port on your TV, or Use a USB power adapter

*The power required for RX is 5V/0.6A (3W).

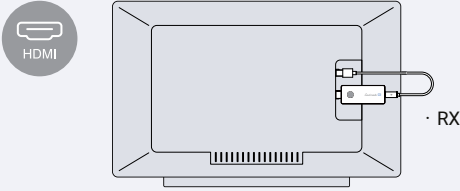

3 Home Screen

Wait until the receiver shows the home screen.



4 Plug The Transmitter (Blue)

Plug into source device's USB-C port. If using an HDMI adapter (sold separately), also connect the USB-C cable for power.

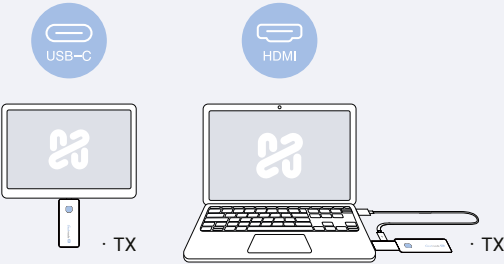

5 Starting Up

The transmitter LED will turn **red** while starting up.

6 Ready

When ready, the LED will turn flashing **blue**.

7 Casting

Press the button on the transmitter to start casting.

The LED will turn solid **blue** when casting.

*The transmission distance is depending on the conditions on site.

Try to use in open spacing with less blockage.

*Walls and glasses will shorten the signal coverage and even cause signal loss.

• Re-pairing Instructions

A set of Castmate 4K includes one Receiver (RX) and one Transmitter (TX), which are already paired.

However, if you need to re-pair, you need to follow the instruction below:

1 Connect The Receiver (Gray)

Connect to the display via HDMI and power it on.

2 Power on the Transmitter (Blue)

The LED will flash **red**.

3 Release

Press and hold the TX button for 4–5 seconds until the **red** LED turns solid, then release.

4 Pairing

The device will enter pairing mode.

When the TX shows a solid **blue** light and the screen displays "TX Paired OK!" pairing is complete.

5 Ready

Unplug and replug the TX.

When the **blue** LED starts flashing, you can begin casting.



AVA Web
avacast.net
Copyright eMPIA Technology Corp.



Product Registration
support/product-registration